

## VARIABLE SPEED PULLEY

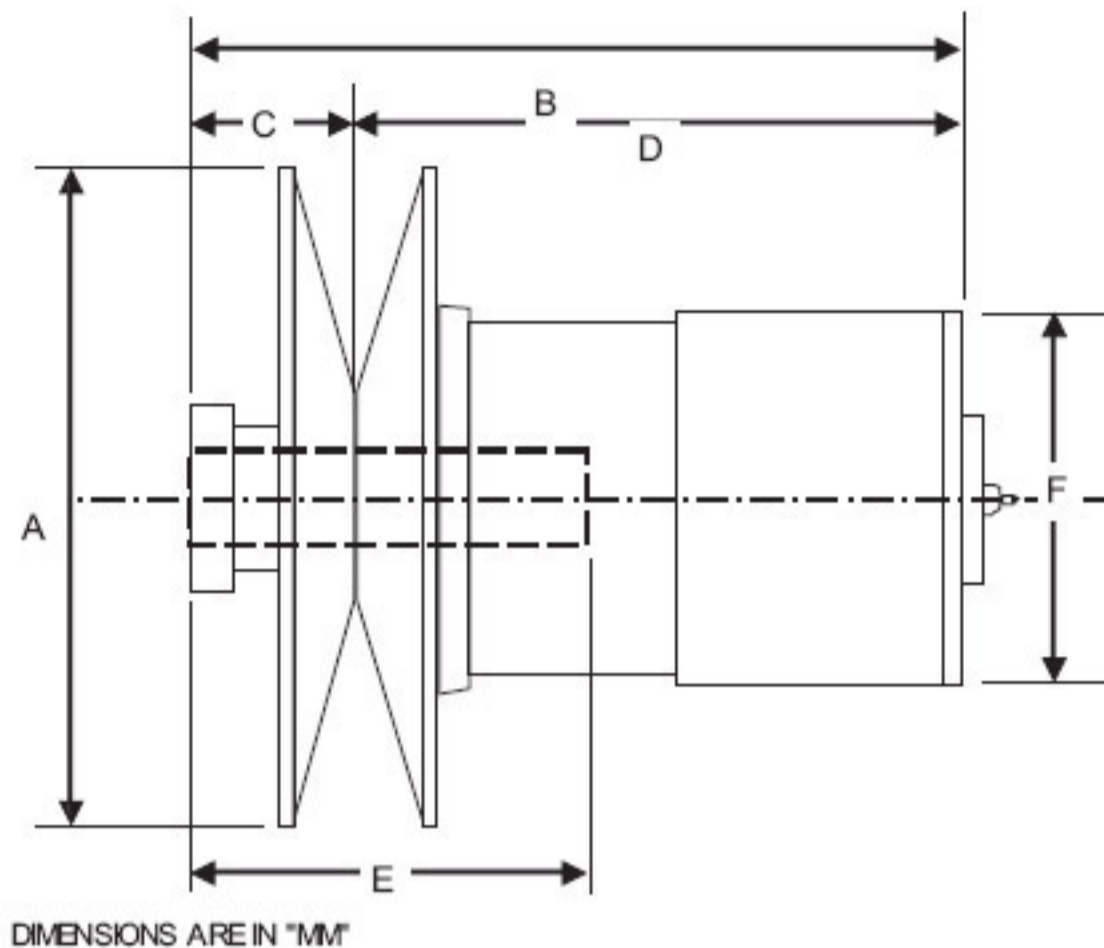

**5P**

## 5P... Variable Speed Pulley



Model	Approx. Speed Range	V-Belt Section	Bore Max. (MM)	Pitch Circle Dia		A	B	C	D	E	F	Min. Dia Driven	ABP
				Max.	Min.								
750	2.3 : 1	28.5 X 9	28	184	79	190	155	34	121	76	104	120	100
775	2.3 : 1	38 X 11	28	187	81	197	170	38	132	76	108	150	100
887	2.6 : 1	38 X 11	32	216	84	225	179	46	133	92	122	150	200
1012	2.6 : 1	38 X 11	38	248	94	257	194	40	154	95	132	150	200
1300	2.9 : 1	50 X 13.5	42	318	110	330	224	51	173	124	153	180	300

### INSTALLATION OF VARIABLE SPEED DRIVE

Since every Variable Speed Pulley are completely inspected before leaving our works, it is not necessary for any further adjustments to be made. However, to ensure maximum efficiency, trouble-free running, & to check for any damage in transit.

- 1 ) Mount the Motor on the Adjustable Base
- 2 ) Fit the Variable Speed Pulley on the Motor Shaft using a side fitting parallel key & secure the Pulley to the Shaft by tightening the two grub screws in the collar.
- 3 ) Fit & secure the grooved fixed pulley to the driven shaft.
- 4 ) Place the Adjustable base, with motor & Variable Speed Pulley, in its approximate position.
- 5 ) Turn the adjustable base hand wheel so that the motor is in its nearest position to the driven Pulley & then place the belt over both Pulleys & pull the base back until the Belt just enters both fixed & expanding grooves, but is slack enough to permit
- 6 ) Line up the two Pulleys using a straight edge.
- 7 ) Secure the Adjustable base to its foundation or support.
- 8 ) Turn the Adjustable base hand wheel so that the Belt fully enters the Variable Speed Pulley groove, & make a further check on the drive alignment. Make any necessary required adjustments to the base position.
- 9 ) Start the motor & ensure that the Belt can move through its full range from maximum pitch diameter to

## 5P... Variable Speed Pulley

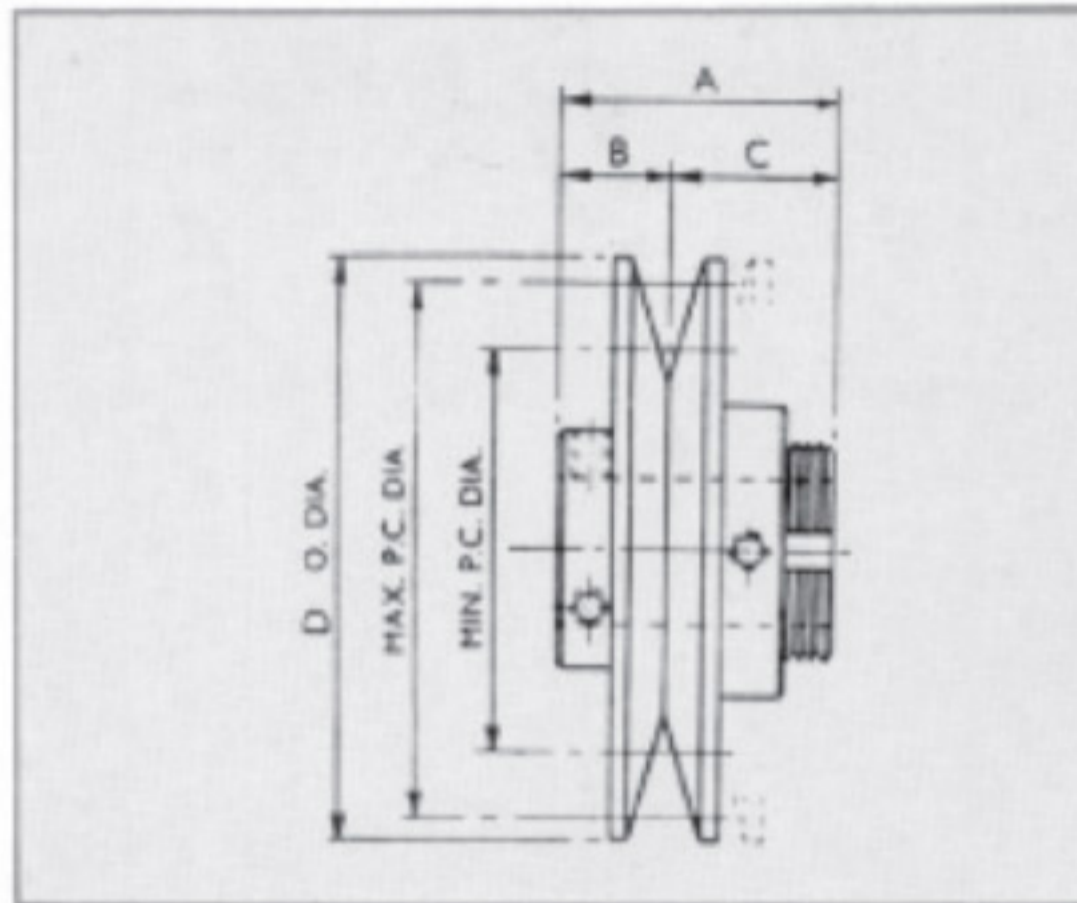

### Dimensions & Power Ratings

Model	Type of V-Belt	Max. P.C.D.	Min. P.C.D.	Power (K.W) At 1440 RPM		D	A	B	C	Grub Screw	Max. Bore
				Max. P.C.D.	Min. P.C.D.						
LP250	2000	59	37	0.20	0.04	64	37	14	22	M5	16
LP325	3000	77	37	0.53	0.16	83	48	19	29	M6	20
	A	78	47	0.50	0.04						
LP362	3000	87	57	0.68	0.21	93	48	19	29	M6	25.4
	A	88	61	0.67	0.21						
LP400	3000	96	66	0.80	0.39	102	48	19	29	M6	25.4
	A	97	70	0.83	0.37						
LP450	3000	109	79	0.91	0.54	114	48	19	29	M6	25.4
	A	110	83	1.03	0.55						
LP500	3000	122	92	1.04	0.72	127	48	19	29	M6	32
	A	123	96	1.25	0.80						
LP550	3000	134	104	1.15	0.87	140	48	19	29	M6	32
	A	135	108	1.45	1.01						
LP600	B	145	109	2.02	1.00	152	54	21	33	M6	32
LP650	B	157	121	2.37	1.37	165	54	21	33	M6	32
LP700	B	170	134	2.71	1.69	178	54	21	33	M6	38
LP750	B	183	147	3.04	2.07	190	54	21	33	M6	38