

IMPERIAL PULLEY



4P

4P... Imperial Pulley

A SECTION																
Outside Dia (Inches)	No of Grooves	Bore Range		TYPE	F	J	L	M	N	T	P	K	R	S	W	Y
		Pilot Bore	Max. Bore													
2"	1		15	1	20		35	15	25	8		M10				
2.5"	1		25	1	20		35	15	40	8		M10				
3"	1	10	30	1	20	42	35	15	45	8	6	M10				
3.5"	1	10	30	1	20	55	35	15	45	8	6	M10				
4"	1	10	30	1	20	68	35	15	45	8	6	M10				
5"	1	10	35	1	20	93	35	15	50	8	6	M10				
6"	1	14	40	7	20	118	35	15	60	8	6	M10			8	
7"	1	14	40	5	20	144	35	15	60	8	5	M10			10	20
8"	1	14	40	5	20	169	35	15	60	8	5	M10			10	20
9"	1	14	40	5	20	195	35	15	60	8	5	M10			10	20
10"	1	14	45	5	20	220	35	15	70	8	4	M10			12	25
11"	1	14	45	5	20	245	35	15	70	8	4	M10			12	25
12"	1	14	45	5	20	271	35	15	70	8	4	M10			12	25
13"	1	16	50	5	20	293	40	20	75	10		M10	278	90	15	30
14"	1	16	50	5	20	318	40	20	75	10		M10	303	90	15	30
15"	1	16	55	5	20	343	45	25	82	10		M10	328	97	15	30
16"	1	16	55	5	20	369	45	25	82	10		M10	354	97	15	30
17"	1	20	60	5	20	394	50	30	90	10		M10	379	105	17	35
18"	1	20	60	5	20	420	50	30	90	10		M10	405	105	17	35
19"	1	20	60	5	20	445	50	30	90	10		M10	430	105	17	35
20"	1	20	60	5	20	470	50	30	90	10		M10	455	105	17	35

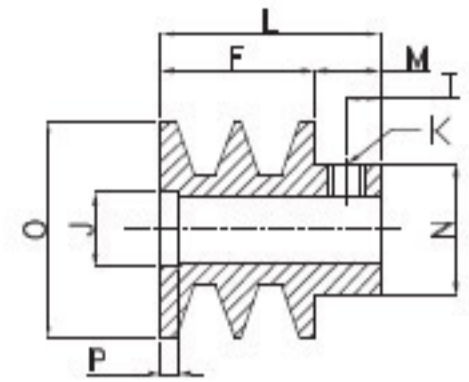

TYPE: S

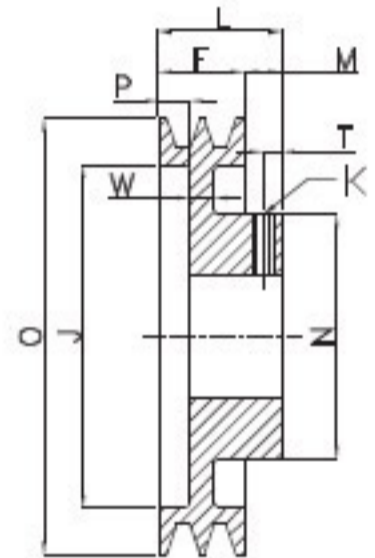

TYPE: D

A SECTION																
Outside Dia (Inches)	No of Grooves	Bore Range		TYPE	F	J	L	M	N	T	P	K	R	S	W	Y
		Pilot Bore	Max. Bore													
2"	2		15	1	35		50	15	25	8		M10				
2.5"	2	10	25	1	35		50	15	40	8		M10				
3"	2	14	30	1	35	42	50	15	45	8	20	M10				
3.5"	2	14	30	1	35	55	50	15	45	8	20	M10				
4"	2	14	40	1	35	68	50	15	60	8	20	M10				
5"	2	14	40	1	35	93	50	15	60	8	20	M10				
6"	2	19	45	7	35	118	50	15	70	8	12	M10			10	
7"	2	19	50	5	35	144	55	20	75	8	12	M10			10	20
8"	2	19	50	5	35	169	55	20	75	8	12	M10			10	20
9"	2	19	50	5	35	195	55	20	75	8	12	M10			10	20
10"	2	19	60	5	35	220	55	20	90	8	10	M10			15	30
11"	2	19	60	5	35	245	55	20	90	8	10	M10			15	30
12"	2	19	60	5	35	271	55	20	90	8	10	M10			15	30
13"	2	16	50	5	35	293	59	24	90	10	9	M10	278	105	18	36
14"	2	16	50	5	35	318	59	24	90	10	9	M10	303	105	18	36
15"	2	16	55	5	35	343	59	24	90	10	9	M10	328	105	18	36
16"	2	16	55	5	35	369	59	24	90	10	9	M10	354	105	18	36
17"	2	20	65	5	35	394	63	28	100	10	8	M10	379	115	20	40
18"	2	25	65	5	35	420	63	28	100	10	8	M10	405	115	20	40
19"	2	25	65	5	35	445	63	28	100	10	8	M10	430	115	20	40
20"	2	25	60	5	35	470	63	28	100	10	8	M10	455	115	20	40
21"	2	25	75	5	35	496	70	35	115	10	5	M10	481	130	22	44
22"	2	25	75	5	35	521	70	35	115	10	5	M10	506	130	22	44
23"	2	25	75	5	35	547	70	35	115	10	5	M10	532	130	22	44
24"	2	25	75	5	35	572	70	35	115	10	5	M10	557	130	22	44

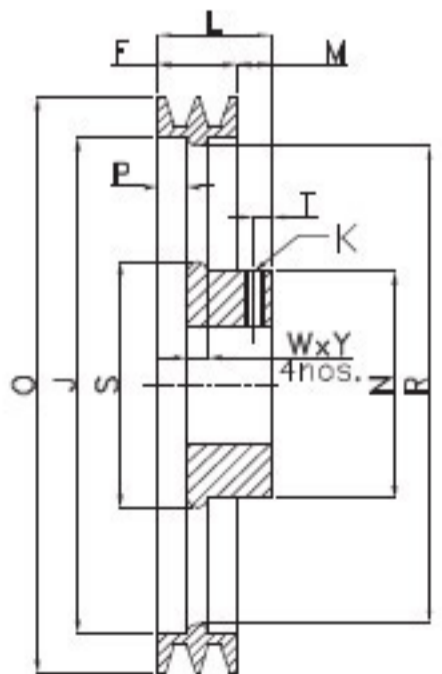

TYPE: A

All dimensions are in mm unless otherwise specified, In view of our constant endeavor to improve the quality of our products, we reserve the right to alter or change specifications without prior notice.

4P... Imperial Pulley

B SECTION																
Outside Dia (Inches)	No of Grooves	Bore Range		TYPE	F	J	L	M	N	T	P	K	R	S	W	Y
		Pilot Bore	Max. Bore													
2"	2		10	1	44		59	15	25	8		M10				
3"	2	14	30	1	44		59	15	45	8		M10				
3.5"	2	14	35	1	44	47	59	15	50	8	24	M10				
4"	2	14	40	1	44	60	59	15	60	8	24	M10				
5"	2	14	40	1	44	85	59	15	60	8	24	M10				
6"	2	19	50	1	44	110.4	59	15	75	8	24	M10				
7"	2	19	50	7	44	135.8	59	15	75	8	16	M10			12	
8"	2	19	50	5	44	161.2	59	15	75	8	16	M10			12	25
9"	2	19	60	5	44	186.6	59	15	90	8	16	M10			12	25
10"	2	19	60	5	44	212	59	15	90	8	14	M10			18	36
11"	2	19	60	5	44	237.4	59	15	90	8	14	M10			18	36
12"	2	19	60	5	44	262.8	59	15	90	8	14	M10			18	36
13"	2	19	60	5	44	281	62	18	90	10	12	M10	266	105	20	40
14"	2	25	75	5	44	307	75	31	115	10	10	M10	292	130	20	40
15"	2	25	75	5	44	332	75	31	115	10	10	M10	317	130	22	44
16"	2	25	75	5	44	357	75	31	115	10	10	M10	342	130	22	44
17"	2	25	75	5	44	383	75	31	115	10	10	M10	368	130	22	44
18"	2	25	75	5	44	408	77	33	115	10	12	M10	393	130	25	50
19"	2	25	75	5	44	434	77	33	115	10	12	M10	419	130	25	50
20"	2	25	75	5	44	459	77	33	115	10	12	M10	444	130	25	50
21"	2	25	75	5	44	484	77	33	115	10	12	M10	469	130	25	50
22"	2	25	75	5	44	510	77	33	115	10	12	M10	495	130	25	50
23"	2	25	75	5	44	535	77	33	115	10	12	M10	520	130	25	50
24"	2	25	75	5	44	561	77	33	115	10	12	M10	536	130	25	50
3"	3	14	30	1	63		78	15	45	8		M10				
3.5"	3	14	35	1	63	47	78	15	50	8	43	M10				
4"	3	14	40	1	63	60	78	15	60	8	43	M10				
5"	3	14	40	1	63	85	78	15	60	8	43	M10				
6"	3	19	50	1	63	110.4	78	15	75	8	35	M10				
7"	3	19	55	7	63	135.8	78	15	80	8	24	M10			15	
8"	3	19	60	7	63	161.2	85	22	90	8	24	M10			15	
9"	3	19	65	5	63	186.6	90	27	100	8	24	M10			15	30
10"	3	25	70	5	63	212	95	32	105	8	24	M10			20	40
11"	3	25	70	5	63	237.4	95	32	105	8	22	M10			20	40
12"	3	25	75	5	63	262.8	100	37	115	8	22	M10			20	40
13"	3	25	75	5	63	281	85	22	115	10	20	M10	266	130	22	44
14"	3	25	90	5	63	307	85	22	115	10	20	M10	292	130	22	44
15"	3	35	90	5	63	332	100	37	135	10	20	M10	317	150	25	50
16"	3	35	90	5	63	357	100	37	135	10	20	M10	342	150	25	50
17"	3	35	90	5	63	383	100	37	135	10	20	M10	368	150	25	50
18"	3	35	90	5	63	408	98	35	135	10	18	M10	393	150	27	55
19"	3	35	90	5	63	434	98	35	135	10	18	M10	419	150	27	55
20"	3	35	90	5	63	459	98	35	135	10	18	M10	444	150	27	55
21"	3	40	100	5	63	484	108	45	150	10	18	M10	469	165	28	56
22"	3	40	100	5	63	510	108	45	150	10	18	M10	495	165	28	56
23"	3	40	100	5	63	535	108	45	150	10	18	M10	520	165	28	56
24"	3	40	100	5	63	561	108	45	150	10	18	M10	536	165	28	56

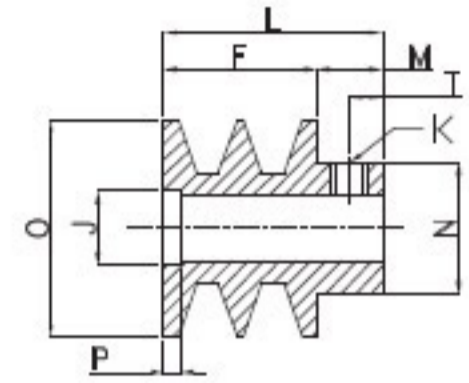

TYPE: S

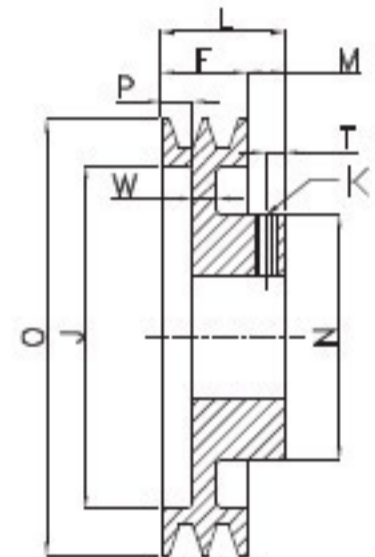

TYPE: D

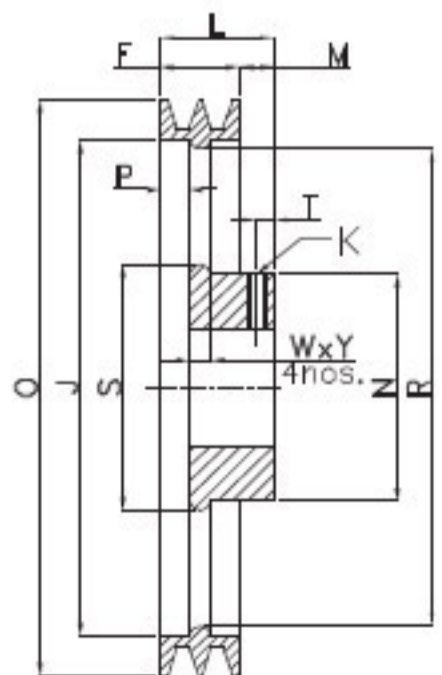

TYPE: A

All dimensions are in mm unless otherwise specified, In view of our constant endeavor to improve the quality of our products, we reserve the right to alter or change specifications without prior notice.

4P... Imperial Pulley

B SECTION																
Outside Dia (Inches)	No of Grooves	Bore Range		TYPE	F	J	L	M	N	T	P	K	R	S	W	Y
		Pilot Bore	Max. Bore													
2"	2		10	1	44		59	15	25	8		M10				
3"	2	14	30	1	44		59	15	45	8		M10				
3.5"	2	14	35	1	44	47	59	15	50	8	24	M10				
4"	2	14	40	1	44	60	59	15	60	8	24	M10				
5"	2	14	40	1	44	85	59	15	60	8	24	M10				
6"	2	19	50	1	44	110.4	59	15	75	8	24	M10				
7"	2	19	50	7	44	135.8	59	15	75	8	16	M10			12	
8"	2	19	50	5	44	161.2	59	15	75	8	16	M10			12	25
9"	2	19	60	5	44	186.6	59	15	90	8	16	M10			12	25
10"	2	19	60	5	44	212	59	15	90	8	14	M10			18	36
11"	2	19	60	5	44	237.4	59	15	90	8	14	M10			18	36
12"	2	19	60	5	44	262.8	59	15	90	8	14	M10			18	36
13"	2	19	60	5	44	281	62	18	90	10	12	M10	266	105	20	40
14"	2	25	75	5	44	307	75	31	115	10	10	M10	292	130	20	40
15"	2	25	75	5	44	332	75	31	115	10	10	M10	317	130	22	44
16"	2	25	75	5	44	357	75	31	115	10	10	M10	342	130	22	44
17"	2	25	75	5	44	383	75	31	115	10	10	M10	368	130	22	44
18"	2	25	75	5	44	408	77	33	115	10	12	M10	393	130	25	50
19"	2	25	75	5	44	434	77	33	115	10	12	M10	419	130	25	50
20"	2	25	75	5	44	459	77	33	115	10	12	M10	444	130	25	50
21"	2	25	75	5	44	484	77	33	115	10	12	M10	469	130	25	50
22"	2	25	75	5	44	510	77	33	115	10	12	M10	495	130	25	50
23"	2	25	75	5	44	535	77	33	115	10	12	M10	520	130	25	50
24"	2	25	75	5	44	561	77	33	115	10	12	M10	536	130	25	50
3"	3	14	30	1	63		78	15	45	8		M10				
3.5"	3	14	35	1	63	47	78	15	50	8	43	M10				
4"	3	14	40	1	63	60	78	15	60	8	43	M10				
5"	3	14	40	1	63	85	78	15	60	8	43	M10				
6"	3	19	50	1	63	110.4	78	15	75	8	35	M10				
7"	3	19	55	7	63	135.8	78	15	80	8	24	M10			15	
8"	3	19	60	7	63	161.2	85	22	90	8	24	M10			15	
9"	3	19	65	5	63	186.6	90	27	100	8	24	M10			15	30
10"	3	25	70	5	63	212	95	32	105	8	24	M10			20	40
11"	3	25	70	5	63	237.4	95	32	105	8	22	M10			20	40
12"	3	25	75	5	63	262.8	100	37	115	8	22	M10			20	40
13"	3	25	75	5	63	281	85	22	115	10	20	M10	266	130	22	44
14"	3	25	90	5	63	307	85	22	115	10	20	M10	292	130	22	44
15"	3	35	90	5	63	332	100	37	135	10	20	M10	317	150	25	50
16"	3	35	90	5	63	357	100	37	135	10	20	M10	342	150	25	50
17"	3	35	90	5	63	383	100	37	135	10	20	M10	368	150	25	50
18"	3	35	90	5	63	408	98	35	135	10	18	M10	393	150	27	55
19"	3	35	90	5	63	434	98	35	135	10	18	M10	419	150	27	55
20"	3	35	90	5	63	459	98	35	135	10	18	M10	444	150	27	55
21"	3	40	100	5	63	484	108	45	150	10	18	M10	469	165	28	56
22"	3	40	100	5	63	510	108	45	150	10	18	M10	495	165	28	56
23"	3	40	100	5	63	535	108	45	150	10	18	M10	520	165	28	56
24"	3	40	100	5	63	561	108	45	150	10	18	M10	536	165	28	56

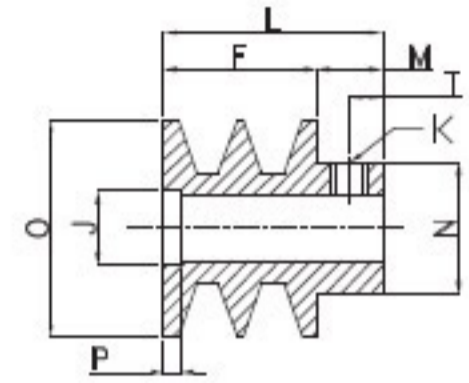

TYPE: S

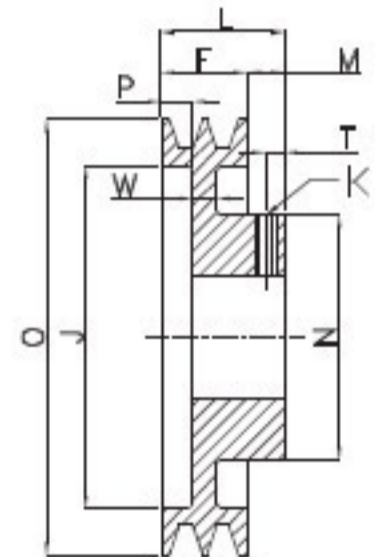

TYPE: D

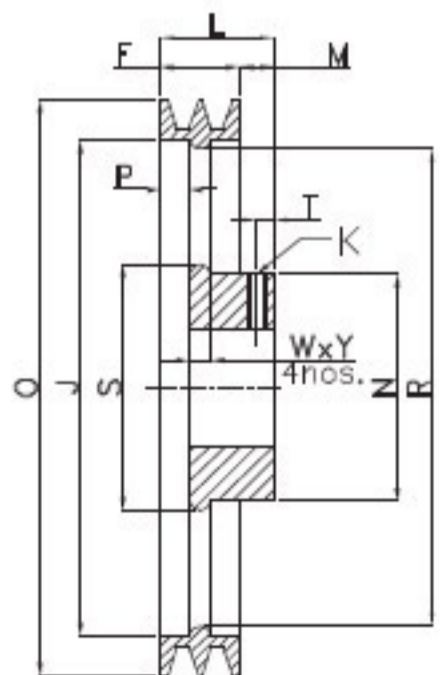

TYPE: A

4P... Imperial Pulley

B SECTION																
Outside Dia (Inches)	No of Grooves	Bore Range		TYPE	F	J	L	M	N	T	P	K	R	S	W	Y
		Pilot Bore	Max. Bore													
3"	4	14	30	1	82		97	15	45	8		M10				
3.5"	4	14	35	1	82	47	97	15	50	8	62	M10				
4"	4	14	40	1	82	60	97	15	60	8	62	M10				
5"	4	14	50	1	82	85	97	15	75	8	52	M10				
6"	4	19	50	1	82	110.4	97	15	75	8	52	M10				
7"	4	19	60	1	82	135.8	97	15	90	8	47	M10				
8"	4	25	60	7	82	161.2	97	15	90	8	31	M10			20	
9"	4	25	65	5	82	186.6	97	15	100	8	31	M10			20	40
10"	4	25	75	5	82	212	97	15	115	8	29	M10			25	50
11"	4	25	75	5	82	237.4	97	15	115	8	29	M10			25	50
12"	4	35	75	5	82	262.8	97	15	115	8	29	M10			25	50
13"	4	35	90	5	82	281	110	28	135	10	30	M10	266	150	25	50
14"	4	35	90	5	82	307	110	28	135	10	30	M10	292	150	25	50
15"	4	35	90	5	82	332	107	25	135	10	27	M10	317	150	27	55
16"	4	35	90	5	82	357	107	25	135	10	27	M10	342	150	27	55
17"	4	35	90	5	82	383	107	25	135	10	27	M10	368	150	27	55
18"	4	35	90	5	82	408	107	25	135	10	27	M10	393	150	30	60
19"	4	35	90	5	82	434	107	25	135	10	27	M10	419	150	30	60
20"	4	35	90	5	82	459	107	25	135	10	27	M10	444	150	30	60
21"	4	40	100	5	82	484	115	33	150	10	25	M10	469	165	31	62
22"	4	40	100	5	82	510	115	33	150	10	25	M10	495	165	31	62
23"	4	40	100	5	82	535	115	33	150	10	25	M10	520	165	31	62
24"	4	40	100	5	82	561	115	33	150	10	25	M10	536	165	31	62

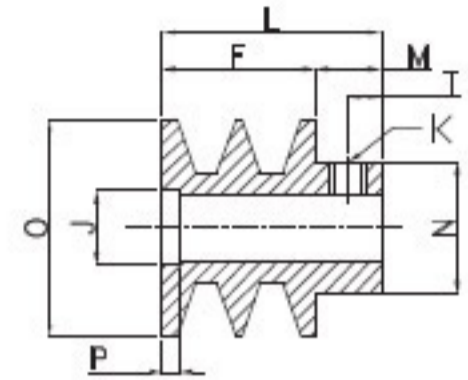

TYPE: S

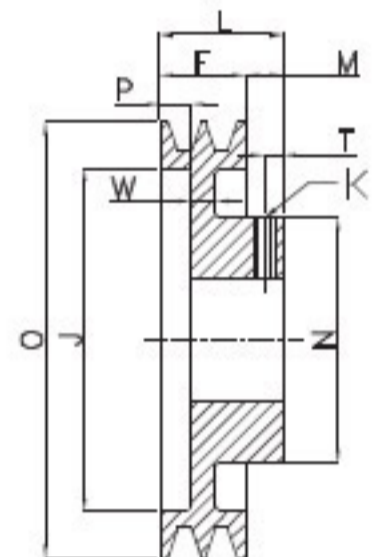

TYPE: D

C SECTION																
Outside Dia (Inches)	No of Grooves	Bore Range		TYPE	F	J	L	M	N	T	P	K	R	S	W	Y
		Pilot Bore	Max. Bore													
3"	2	10	40	1	60		75	15	60	8		M10				
4"	2	14	40	1	60	46	75	15	60	8	35	M10				
5"	2	14	50	1	60	71	75	15	75	8	30	M10				
6"	2	19	55	1	60	96	75	15	85	8	25	M10				
7"	2	19	55	1	60	121.8	75	15	85	8	25	M10				
8"	2	19	55	7	60	147.2	75	15	85	8	25	M10			18	
9"	2	19	60	5	60	172.6	75	15	90	8	25	M10			18	36
10"	2	19	60	5	60	198	75	15	90	8	20	M10			20	40
11"	2	19	75	5	60	223.4	85	25	115	8	20	M10			20	40
12"	2	19	75	5	60	248.8	85	25	115	8	20	M10			20	40
13"	2	25	75	5	60	268	85	25	115	10	20	M10	253	130	25	50
14"	2	25	75	5	60	294	85	25	115	10	20	M10	279	130	25	50
15"	2	25	75	5	60	319	85	25	115	10	20	M10	304	130	25	50
16"	2	35	90	5	60	344	97	37	135	10	17	M10	329	150	27	55
17"	2	35	90	5	60	370	97	37	135	10	17	M10	355	150	27	55
18"	2	35	90	5	60	395	95	35	135	10	15	M10	380	150	29	58
19"	2	35	90	5	60	421	95	35	135	10	15	M10	406	150	29	58
20"	2	35	90	5	60	446	95	35	135	10	15	M10	431	150	29	58
21"	2	40	100	5	60	471	105	45	150	10	15	M10	456	165	30	60
22"	2	40	100	5	60	497	105	45	150	10	15	M10	482	165	30	60
23"	2	40	100	5	60	522	105	45	150	10	15	M10	507	165	30	60
24"	2	40	100	5	60	547	105	45	150	10	15	M10	532	165	30	60

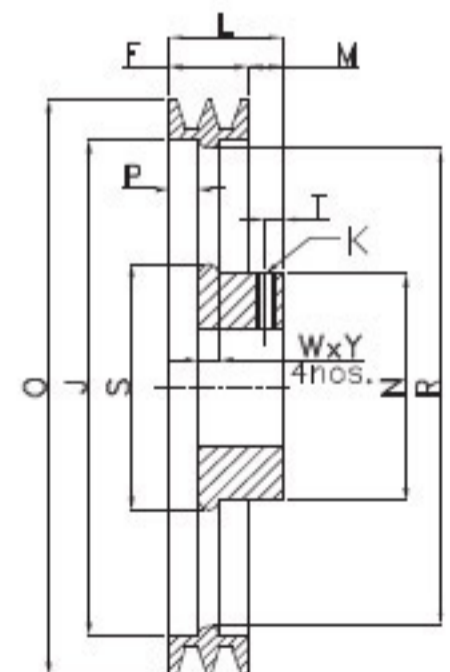

TYPE: A

4P... Imperial Pulley

C SECTION																
Outside Dia (Inches)	No of Grooves	Bore Range		TYPE	F	J	L	M	N	T	P	K	R	S	W	Y
		Pilot Bore	Max. Bore													
4"	3	14	40	1	85	46	100	15	60	8	60	M10				
5"	3	14	50	1	85	71	100	15	75	8	55	M10				
6"	3	19	55	1	85	96	100	15	85	8	50	M10				
7"	3	19	60	1	85	121.8	100	15	90	8	50	M10				
8"	3	19	60	7	85	147.2	100	15	90	8	45	M10			20	
9"	3	19	65	7	85	172.6	100	15	100	8	45	M10			20	
10"	3	25	65	5	85	198	100	15	100	8	40	M10			25	50
11"	3	25	75	5	85	223.4	100	15	115	8	35	M10			25	50
12"	3	35	75	5	85	248.8	100	15	115	8	35	M10			25	50
13"	3	35	90	5	85	268	109	24	135	10	29	M10	253	150	27	55
14"	3	35	90	5	85	294	109	24	135	10	29	M10	279	150	27	55
15"	3	35	90	5	85	319	109	24	135	10	29	M10	304	150	27	55
16"	3	35	90	5	85	344	108	23	135	10	28	M10	329	150	29	58
17"	3	40	100	5	85	370	118	33	150	10	28	M10	355	165	29	58
18"	3	40	100	5	85	395	117	32	150	10	27	M10	380	165	31	62
19"	3	40	100	5	85	421	117	32	150	10	27	M10	406	165	31	62
20"	3	40	100	5	85	446	117	32	150	10	27	M10	431	165	31	62
21"	3	40	100	5	85	471	116	31	150	10	26	M10	456	165	33	66
22"	3	40	100	5	85	497	116	31	150	10	26	M10	482	165	33	66
23"	3	40	100	5	85	522	116	31	150	10	26	M10	507	165	33	66
24"	3	50	110	5	85	547	126	41	165	10	26	M10	532	180	33	66

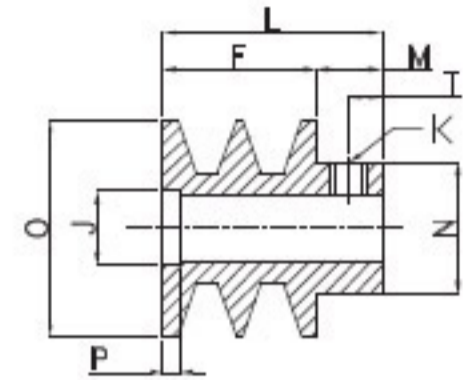

TYPE: S

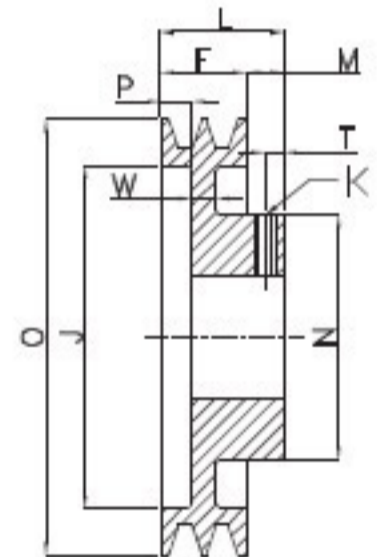

TYPE: D

C SECTION																
Outside Dia (Inches)	No of Grooves	Bore Range		TYPE	F	J	L	M	N	T	P	K	R	S	W	Y
		Pilot Bore	Max. Bore													
4"	4	14	40	1	111	46	126	15	60	8	86	M10				
5"	4	14	55	1	111	71	126	15	80	8	76	M10				
6"	4	19	55	1	111	96	126	15	80	8	76	M10				
7"	4	25	60	1	111	121.8	126	15	90	8	76	M10				
8"	4	35	65	1	111	147.2	126	15	100	8	71	M10				
9"	4	35	75	7	111	172.6	126	15	115	8	56	M10			20	
10"	4	35	75	5	111	198	126	15	115	8	56	M10			28	56
11"	4	35	90	5	111	223.4	126	15	135	8	46	M10			28	56
12"	4	35	90	5	111	248.8	126	15	135	8	46	M10			28	56
13"	4	40	100	5	111	268	130	19	150	10	40	M10	253	165	30	60
14"	4	40	100	5	111	294	130	19	150	10	40	M10	279	165	30	60
15"	4	40	100	5	111	319	130	19	150	10	40	M10	304	165	30	60
16"	4	40	100	5	111	344	130	19	150	10	40	M10	329	165	32	64
17"	4	50	110	5	111	370	140	29	165	10	40	M10	355	180	32	64
18"	4	50	110	5	111	395	138	27	165	10	38	M10	380	180	35	70
19"	4	50	110	5	111	421	138	27	165	10	38	M10	406	180	35	70
20"	4	50	110	5	111	446	138	27	165	10	38	M10	431	180	35	70
21"	4	50	110	5	111	471	137	45	165	10	37	M10	456	180	37	75
22"	4	50	110	5	111	497	137	45	165	10	37	M10	482	180	37	75
23"	4	50	110	5	111	522	137	45	165	10	37	M10	507	180	37	75
24"	4	50	115	5	111	547	142	45	175	10	37	M10	532	190	37	75

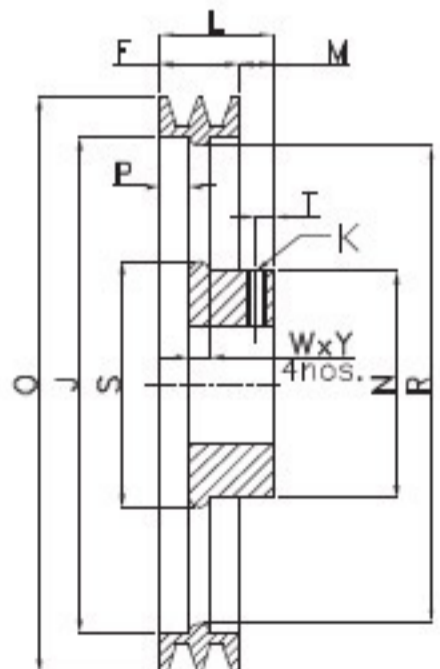

TYPE: A

4P... Imperial Pulley

C SECTION																
Outside Dia (Inches)	No of Grooves	Bore Range		TYPE	F	J	L	M	N	T	P	K	R	S	W	Y
		Pilot Bore	Max. Bore													
4"	5	14	40	1	136	46	151	15	60	8	111	M10				
5"	5	14	55	1	136	71	151	15	80	8	101	M10				
6"	5	19	60	1	136	96	151	15	90	8	101	M10				
7"	5	25	60	1	136	121.8	151	15	90	8	101	M10				
8"	5	35	70	1	136	147.2	151	15	105	8	86	M10				
9"	5	35	75	7	136	172.6	151	15	115	8	66	M10			25	
10"	5	35	75	5	136	198	151	15	115	8	61	M10			30	60
11"	5	35	90	5	136	223.4	151	15	135	8	56	M10			30	60
12"	5	35	90	5	136	248.8	151	15	135	8	56	M10			30	60
13"	5	40	100	5	136	268	152	16	150	10	52	M10	253	165	32	64
14"	5	40	100	5	136	294	152	16	150	10	52	M10	279	165	32	64
15"	5	40	100	5	136	319	152	16	150	10	52	M10	304	165	32	64
16"	5	40	100	5	136	344	151	15	150	10	50	M10	329	165	35	70
17"	5	50	110	5	136	370	151	15	165	10	50	M10	355	180	35	70
18"	5	50	110	5	136	395	151	15	165	10	50	M10	380	180	37	75
19"	5	50	110	5	136	421	151	15	165	10	50	M10	406	180	37	75
20"	5	50	110	5	136	446	151	15	165	10	50	M10	431	180	37	75
21"	5	50	110	5	136	471	151	15	165	10	48	M10	456	180	40	80
22"	5	50	110	5	136	497	151	15	165	10	48	M10	482	180	40	80
23"	5	50	110	5	136	522	151	15	165	10	48	M10	507	180	40	80
24"	5	70	125	5	136	547	158	22	190	10	48	M10	532	205	40	80

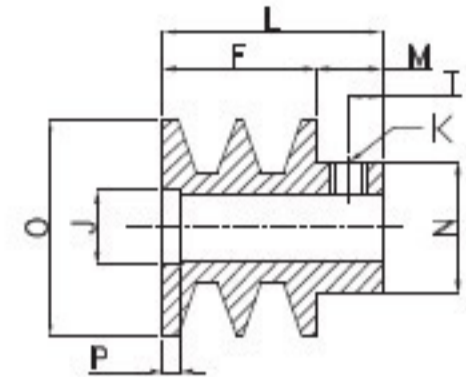

TYPE: S

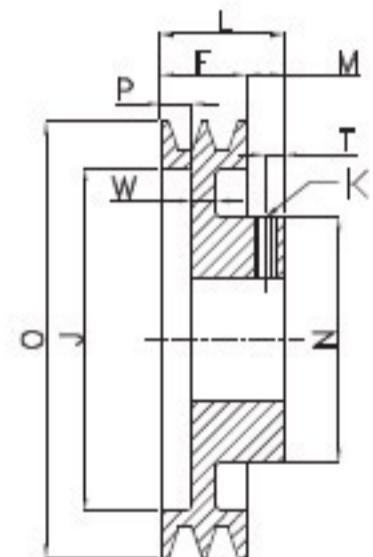

TYPE: D

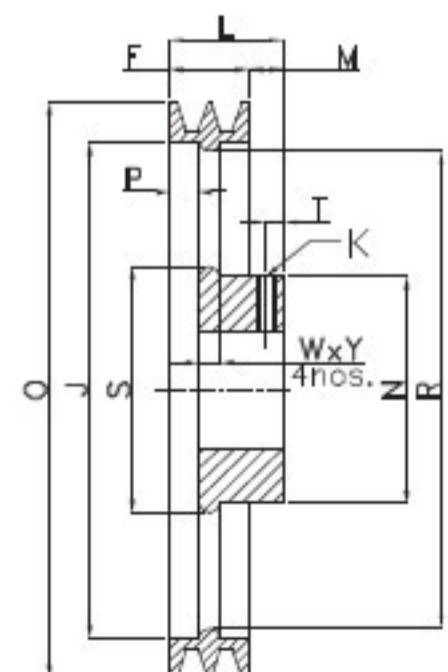

TYPE: A