

COAXIAL HELICAL GR



2G

2G... Co Axial Helical Gear Reducer

Foot Type Helical Geared Motor

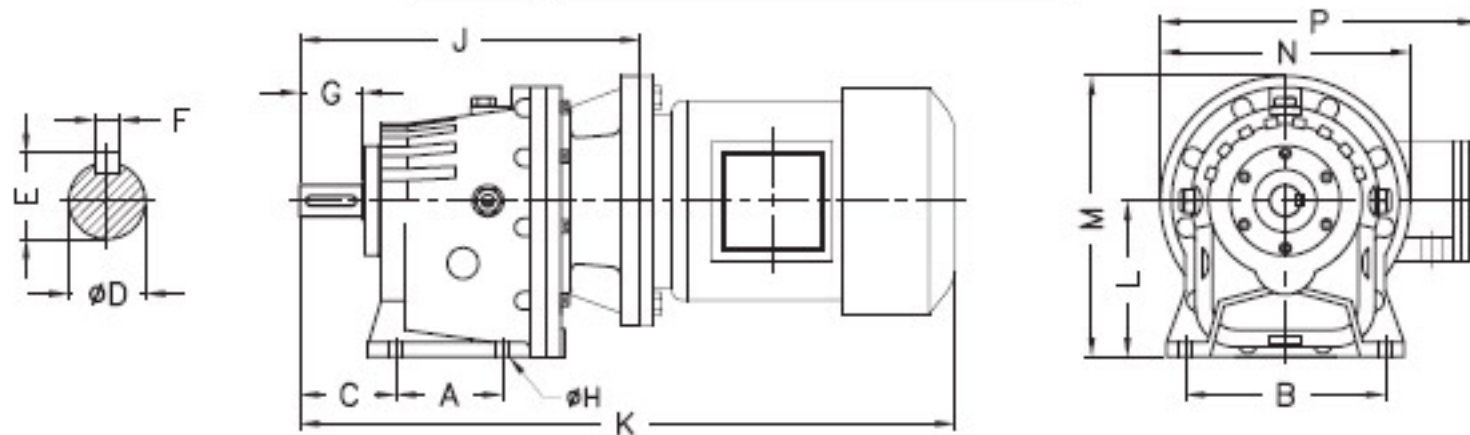

MODEL	MOTOR FRAME	A	B	C	ØD	E	F	G	ØH	J	K	L	M	N	P	
50	71	85	160	78	25	28	8	50	11	273	504	125	216	182	211	
	520										225		200	227		
	525													254		
	550															
60	90S	102	168	85	30	33	8	60	13	303	555	148	248	200	254	
	580										270		250	294		
	609													307		
	631															
70	90L	107	188	95	35	38	10	70	13	317	594	165	274	218	263	
	623										290		250	294		
	645													307		
80	100L	120	210	105	40	43	12	80	16	385	691	182	307	250	294	
	713										307					
	754										331					
90	100L	130	245	115	45	48.5	14	90	16	407	713	202	340	275	307	
	735										320					
	776										352				300	356
	814															
100	100L	142	265	125	50	54	16	100	18	438	744	222	372	300	319	
	766										332					
	845										397				350	401
	807															
	913															
112	100L	160	280	140	55	59	16	112	18	490	796	254	419	330	334	
	818										347					
	859										429				350	401
	897															
	965															
125	132S	175	295	160	60	64	18	125	19	542	911	280	459	358	385	
	949										405					
	1061															
	1017															
	1132														461	
140	132M	200	300	190	70	75	20	140	24	593	1000	268	458	456	472	
	1068										492					
	1112										548					
	1183															
160	160M	230	320	205	80	85.5	22	160	26	640	1115	300	510	512	528	
	1159										584					
	1230															

All dimensions are in mm unless otherwise specified. In view of our constant endeavor to improve the quality of our products, we reserve the right to alter or change specifications without prior notice.

2G... Co Axial Helical Gear Reducer

Flange Type Helical Geared Motor

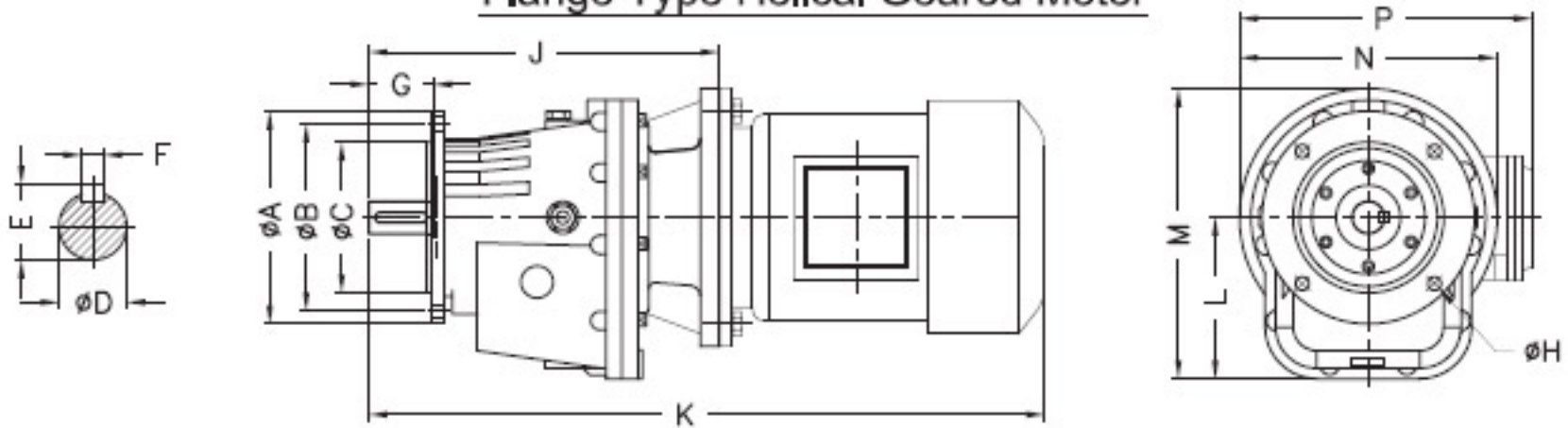

MODEL	MOTOR FRAME	A	B	C	ØD	E	F	G	ØH	J	K	L	M	N	P
50 F	71	165	145	117	25	28	8	50	10.5	273	504	125	216	182	211
	80										520		225	200	227
	90S										525				254
	90L										550				
60 F	90S	195	170	141	30	33	8	60	12	303	555	148	248	200	254
	90L										580		270	250	294
	100L										609				307
	112M										631				
70 F	90L	217	190	165	35	38	10	70	12	317	594	165	274	218	263
	100L										623		290	250	294
	112M										645				307
80 F	100L	250	220	180	40	43	12	80	14	385	691	182	307	250	294
	112M										713				307
	132S										754				331
90 F	100L	275	245	205	45	48.5	14	90	14	407	713	202	340	275	307
	112M										735				320
	132S										776		352	300	356
	132M										814				
100 F	100L	298	265	230	50	54	16	100	18	438	744	222	372	300	319
	112M										766				332
	132M										845				356
	132S										807				356
	160M										913				397
112 F	100L	325	290	250	55	59	16	112	18	490	796	254	419	330	334
	112M										818				347
	132S										859				371
	132M										897				
	160M										965				
125 F	132S	350	310	250	60	64	18	125	19	542	911	280	459	358	385
	132M										949				
	160L										1061				405
	160M										1017				
	180L										1132				461
	180M														
140 F	132M	432	392	335	70	75	20	140	24	593	1000	268	458	456	472
	160M										1068				492
	160L										1112				548
	180M										1183				
160 F	160M	485	445	365	80	85.5	22	160	26	640	1115	300	510	512	528
	160L										1159				
	180M										1230				584
	180L														

All dimensions are in mm unless otherwise specified. In view of our constant endeavor to improve the quality of our products, we reserve the right to alter or change specifications without prior notice.

2G... Co Axial Helical Gear Reducer

Input 1500 RPM

Sr. No.	MODEL	H-50	H-60	H-70	H-80	H-90	H-100	H-112	H-125	H-140	H-160	H-180	H-200	
1	RATIO	3	3	3	3	3	3	3	3	3	3	3	3	
	N2(0/P RPM)	500	500	500	500	500	500	500	500	500	500	500	500	
	HP1	3	7	8	10	14	17.5	22.5	32	37.5	45	70	80	
	KW1	2.25	5.25	6	7.5	10.5	13.125	16.875	24	28.125	33.75	52.5	60	
	T2-NM	42	98	112	140	196	245	316	449	526	631	982	1122	
	DE	98	98	98	98	98	98	98	98	98	98	98	98	98
	M-HP1	2	5	5	7.5	10	12.5	15	20	25	30	40	50	
	M-KW1	1.5	3.75	3.75	5.625	7.5	9.375	11.25	15	18.75	22.5	30	37.5	
	M-T2-NM	28	70	70	105	140	175	210	280	351	421	561	701	
	SF	1.50	1.40	1.60	1.33	1.40	1.40	1.50	1.60	1.50	1.50	1.75	1.60	

	MODEL	H-50	H-60	H-70	H-80	H-90	H-100	H-112	H-125	H-140	H-160	H-180	H-200	
2	RATIO	3.5	3.5	3.5	3.5	3.5	3.5	3.5	3.5	3.5	3.5	3.5	3.5	
	N2(0/P RPM)	428.571	428.57	428.57	428.57	428.57	428.57	428.57	428.57	428.57	428.57	428.57	428.57	
	HP1	3	7	8	10	14	17.5	22.5	32	37.5	45	70	80	
	KW1	2.25	5.25	6	7.5	10.5	13.125	16.875	24	28.125	33.75	52.5	60	
	T2-NM	49	115	131	164	229	286	368	524	614	736	1145	1309	
	DE	98	98	98	98	98	98	98	98	98	98	98	98	98
	M-HP1	2	5	5	7.5	10	12.5	15	20	25	30	40	50	
	M-KW1	1.5	3.75	3.75	5.625	7.5	9.375	11.25	15	18.75	22.5	30	37.5	
	M-T2-NM	33	82	82	123	164	205	245	327	409	491	654	818	
	SF	1.50	1.40	1.60	1.33	1.40	1.40	1.50	1.60	1.50	1.50	1.75	1.60	

	MODEL	H-50	H-60	H-70	H-80	H-90	H-100	H-112	H-125	H-140	H-160	H-180	H-200	
3	RATIO	4.25	4.25	4.25	4.25	4.25	4.25	4.25	4.25	4.25	4.25	4.25	4.25	
	N2(0/P RPM)	352.941	352.94	352.94	352.94	352.94	352.94	352.94	352.94	352.94	352.94	352.94	352.94	
	HP1	3	7	8	10	14	17.5	22.5	32	37.5	45	70	80	
	KW1	2.25	5.25	6	7.5	10.5	13.125	16.875	24	28.125	33.75	52.5	60	
	T2-NM	60	139	159	199	278	348	447	636	745	894	1391	1589	
	DE	98	98	98	98	98	98	98	98	98	98	98	98	98
	M-HP1	2	5	5	7.5	10	12.5	15	20	25	30	40	50	
	M-KW1	1.5	3.75	3.75	5.625	7.5	9.375	11.25	15	18.75	22.5	30	37.5	
	M-T2-NM	40	99	99	149	199	248	298	397	497	596	795	993	
	SF	1.50	1.40	1.60	1.33	1.40	1.40	1.50	1.60	1.50	1.50	1.75	1.60	

	MODEL	H-50	H-60	H-70	H-80	H-90	H-100	H-112	H-125	H-140	H-160	H-180	H-200	
4	RATIO	4.8	4.8	4.8	4.8	4.8	4.8	4.8	4.8	4.8	4.8	4.8	4.8	
	N2(0/P RPM)	312.5	312.5	312.5	312.5	312.5	312.5	312.5	312.5	312.5	312.5	312.5	312.5	
	HP1	2.5	5.5	6.5	9	12.5	16	20	30	35	40	60	75	
	KW1	1.875	4.125	4.875	6.75	9.375	12	15	22.5	26.25	30	45	56.25	
	T2-NM	56	123	146	202	280	359	449	673	785	898	1346	1683	
	DE	98	98	98	98	98	98	98	98	98	98	98	98	98
	M-HP1	1.5	3	5	5	7.5	10	12.5	20	25	25	40	50	
	M-KW1	1.125	2.25	3.75	3.75	5.625	7.5	9.375	15	18.75	18.75	30	37.5	
	M-T2-NM	34	67	112	112	168	224	280	449	561	561	898	1122	
	SF	1.67	1.83	1.30	1.80	1.67	1.60	1.60	1.50	1.40	1.60	1.50	1.50	

2G... Co Axial Helical Gear Reducer

5	MODEL	H-50	H-60	H-70	H-80	H-90	H-100	H-112	H-125	H-140	H-160	H-180	H-200	
	RATIO	6	6	6	6	6	6	6	6	6	6	6	6	6
	N2(0/P RPM)	250	250	250	250	250	250	250	250	250	250	250	250	250
	HP1	2.5	5.5	6.5	9	12.5	16	20	30	35	40	60	75	
	KW1	1.875	4.125	4.875	6.75	9.375	12	15	22.5	26.25	30	45	56.25	
	T2-NM	70	154	182	252	351	449	561	841	982	1122	1683	2104	
	DE	98	98	98	98	98	98	98	98	98	98	98	98	98
	M-HP1	1.5	3	5	5	7.5	10	12.5	20	25	25	40	50	
	M-KW1	1.125	2.25	3.75	3.75	5.625	7.5	9.375	15	18.75	18.75	30	37.5	
	M-T2-NM	42	84	140	140	210	280	351	561	701	701	1122	1402	
SF	1.67	1.83	1.30	1.80	1.67	1.60	1.60	1.50	1.40	1.60	1.50	1.50		

6	MODEL	H-50	H-60	H-70	H-80	H-90	H-100	H-112	H-125	H-140	H-160	H-180	H-200
	RATIO	7	7	7	7	7	7	7	7	7	7	7	7
	N2(0/P RPM)	214.286	214.29	214.29	214.29	214.29	214.29	214.29	214.29	214.29	214.29	214.29	214.29
	HP1	2.5	5.5	6.5	9	12.5	16	20	30	35	40	60	75
	KW1	1.875	4.125	4.875	6.75	9.375	12	15	22.5	26.25	30	45	56.25
	T2-NM	82	180	213	294	409	524	654	982	1145	1309	1963	2454
	DE	98	98	98	98	98	98	98	98	98	98	98	98
	M-HP1	1.5	3	5	5	7.5	10	12.5	20	25	25	40	50
	M-KW1	1.125	2.25	3.75	3.75	5.625	7.5	9.375	15	18.75	18.75	30	37.5
	M-T2-NM	49	98	164	164	245	327	409	654	818	818	1309	1636
SF	1.67	1.83	1.30	1.80	1.67	1.60	1.60	1.50	1.40	1.60	1.50	1.50	

7	MODEL	H-50	H-60	H-70	H-80	H-90	H-100	H-112	H-125	H-140	H-160	H-180	H-200
	RATIO	8	8	8	8	8	8	8	8	8	8	8	8
	N2(0/P RPM)	187.5	187.5	187.5	187.5	187.5	187.5	187.5	187.5	187.5	187.5	187.5	187.5
	HP1	2.5	5.5	6.5	9	12.5	16	20	30	35	40	60	75
	KW1	1.875	4.125	4.875	6.75	9.375	12	15	22.5	26.25	30	45	56.25
	T2-NM	93	206	243	337	467	598	748	1122	1309	1496	2244	2805
	DE	98	98	98	98	98	98	98	98	98	98	98	98
	M-HP1	1.5	3	5	5	7.5	10	12.5	20	25	25	40	50
	M-KW1	1.125	2.25	3.75	3.75	5.625	7.5	9.375	15	18.75	18.75	30	37.5
	M-T2-NM	56	112	187	187	280	374	467	748	935	935	1496	1870
SF	1.67	1.83	1.30	1.80	1.67	1.60	1.60	1.50	1.40	1.60	1.50	1.50	

8	MODEL	H-50	H-60	H-70	H-80	H-90	H-100	H-112	H-125	H-140	H-160	H-180	H-200
	RATIO	9	9	9	9	9	9	9	9	9	9	9	9
	N2(0/P RPM)	166.667	166.67	166.67	166.67	166.67	166.67	166.67	166.67	166.67	166.67	166.67	166.67
	HP1	2.5	5.5	6.5	9	12.5	15	20	30	35	40	60	75
	KW1	1.875	4.125	4.875	6.75	9.375	11.25	15	22.5	26.25	30	45	56.25
	T2-NM	105	231	273	379	526	631	841	1262	1472	1683	2524	3155
	DE	98	98	98	98	98	98	98	98	98	98	98	98
	M-HP1	1.5	3	5	5	7.5	10	12.5	20	25	25	40	50
	M-KW1	1.125	2.25	3.75	3.75	5.625	7.5	9.375	15	18.75	18.75	30	37.5
	M-T2-NM	63	126	210	210	316	421	526	841	1052	1052	1683	2104
SF	1.67	1.83	1.30	1.80	1.67	1.50	1.60	1.50	1.40	1.60	1.50	1.50	

9	MODEL	H-50	H-60	H-70	H-80	H-90	H-100	H-112	H-125	H-140	H-160	H-180	H-200
	RATIO	10	10	10	10	10	10	10	10	10	10	10	10
	N2(0/P RPM)	150	150	150	150	150	150	150	150	150	150	150	150
	HP1	2.5	5.5	6.5	9	12.5	16	20	30	35	40	60	75
	KW1	1.875	4.125	4.875	6.75	9.375	12	15	22.5	26.25	30	45	56.25
	T2-NM	117	257	304	421	584	748	935	1402	1636	1870	2805	3506
	DE	98	98	98	98	98	98	98	98	98	98	98	98
	M-HP1	1.5	3	5	5	7.5	10	12.5	20	25	25	40	50
	M-KW1	1.125	2.25	3.75	3.75	5.625	7.5	9.375	15	18.75	18.75	30	37.5
	M-T2-NM	70	140	234	234	351	467	584	935	1169	1169	1870	2337
SF	1.67	1.83	1.30	1.80	1.67	1.60	1.60	1.50	1.40	1.60	1.50	1.50	

All dimensions are in mm unless otherwise specified. In view of our constant endeavor to improve the quality of our products, we reserve the right to alter or change specifications without prior notice.

2G... Co Axial Helical Gear Reducer

10	MODEL	H-50	H-60	H-70	H-80	H-90	H-100	H-112	H-125	H-140	H-160	H-180	H-200	
	RATIO	11.2	11.2	11.2	11.2	11.2	11.2	11.2	11.2	11.2	11.2	11.2	11.2	11.2
	N2(0/P RPM)	133.929	133.93	133.93	133.93	133.93	133.93	133.93	133.93	133.93	133.93	133.93	133.93	133.93
	HP1	2.5	4	5.5	7.5	10	12.5	15	25	30	40	60	75	
	KW1	1.875	3	4.125	5.625	7.5	9.375	11.25	18.75	22.5	30	45	56.25	
	T2-NM	131	209	288	393	524	654	785	1309	1571	2094	3141	3927	
	DE	98	98	98	98	98	98	98	98	98	98	98	98	98
	M-HP1	1.5	3	3	5	7.5	7.5	10	15	20	25	40	50	
	M-KW1	1.125	2.25	2.25	3.75	5.625	5.625	7.5	11.25	15	18.75	30	37.5	
	M-T2-NM	79	157	157	262	393	393	524	785	1047	1309	2094	2618	
SF	1.67	1.33	1.83	1.50	1.33	1.67	1.50	1.67	1.50	1.60	1.50	1.50		

11	MODEL	H-50	H-60	H-70	H-80	H-90	H-100	H-112	H-125	H-140	H-160	H-180	H-200	
	RATIO	12.5	12.5	12.5	12.5	12.5	12.5	12.5	12.5	12.5	12.5	12.5	12.5	
	N2(0/P RPM)	120	120	120	120	120	120	120	120	120	120	120	120	
	HP1	2	4	5.5	7.5	10	12.5	15	25	30	40	60	75	
	KW1	1.5	3	4.125	5.625	7.5	9.375	11.25	18.75	22.5	30	45	56.25	
	T2-NM	117	234	321	438	584	730	876	1461	1753	2337	3506	4382	
	DE	98	98	98	98	98	98	98	98	98	98	98	98	98
	M-HP1	1.5	3	3	5	7.5	7.5	10	15	20	25	40	50	
	M-KW1	1.125	2.25	2.25	3.75	5.625	5.625	7.5	11.25	15	18.75	30	37.5	
	M-T2-NM	88	175	175	292	438	438	584	876	1169	1461	2337	2922	
SF	1.33	1.33	1.83	1.50	1.33	1.67	1.50	1.67	1.50	1.60	1.50	1.50		

12	MODEL	H-50	H-60	H-70	H-80	H-90	H-100	H-112	H-125	H-140	H-160	H-180	H-200	
	RATIO	14	14	14	14	14	14	14	14	14	14	14	14	
	N2(0/P RPM)	107.143	107.14	107.14	107.14	107.14	107.14	107.14	107.14	107.14	107.14	107.14	107.14	
	HP1	2	3	5.5	6	7.5	12.5	15	25	30	40	60	75	
	KW1	1.5	2.25	4.125	4.5	5.625	9.375	11.25	18.75	22.5	30	45	56.25	
	T2-NM	131	196	360	393	491	818	982	1636	1963	2618	3927	4908	
	DE	98	98	98	98	98	98	98	98	98	98	98	98	98
	M-HP1	1.5	2	3	3	5	7.5	10	15	20	25	40	50	
	M-KW1	1.125	1.5	2.25	2.25	3.75	5.625	7.5	11.25	15	18.75	30	37.5	
	M-T2-NM	98	131	196	196	327	491	654	982	1309	1636	2618	3272	
SF	1.33	1.50	1.83	2.00	1.50	1.67	1.50	1.67	1.50	1.60	1.50	1.50		

13	MODEL	H-50	H-60	H-70	H-80	H-90	H-100	H-112	H-125	H-140	H-160	H-180	H-200	
	RATIO	16	16	16	16	16	16	16	16	16	16	16	16	
	N2(0/P RPM)	93.75	93.75	93.75	93.75	93.75	93.75	93.75	93.75	93.75	93.75	93.75	93.75	
	HP1	2	3	5.5	6	7.5	12.5	15	25	30	40	60	75	
	KW1	1.5	2.25	4.125	4.5	5.625	9.375	11.25	18.75	22.5	30	45	56.25	
	T2-NM	150	224	411	449	561	935	1122	1870	2244	2992	4488	5610	
	DE	98	98	98	98	98	98	98	98	98	98	98	98	98
	M-HP1	1.5	2	3	3	5	7.5	10	15	20	25	40	50	
	M-KW1	1.125	1.5	2.25	2.25	3.75	5.625	7.5	11.25	15	18.75	30	37.5	
	M-T2-NM	112	150	224	224	374	561	748	1122	1496	1870	2992	3740	
SF	1.33	1.50	1.83	2.00	1.50	1.67	1.50	1.67	1.50	1.60	1.50	1.50		

14	MODEL	H-50	H-60	H-70	H-80	H-90	H-100	H-112	H-125	H-140	H-160	H-180	H-200	
	RATIO	18	18	18	18	18	18	18	18	18	18	18	18	
	N2(0/P RPM)	83.3333	83.333	83.333	83.333	83.333	83.333	83.333	83.333	83.333	83.333	83.333	83.333	
	HP1	1.5	3	4	6	7.5	10	12.5	25	30	40	60	75	
	KW1	1.125	2.25	3	4.5	5.625	7.5	9.375	18.75	22.5	30	45	56.25	
	T2-NM	126	252	337	505	631	841	1052	2104	2524	3366	5049	6311	
	DE	98	98	98	98	98	98	98	98	98	98	98	98	98
	M-HP1	1	2	2	3	5	7.5	7.5	15	20	25	40	50	
	M-KW1	0.75	1.5	1.5	2.25	3.75	5.625	5.625	11.25	15	18.75	30	37.5	
	M-T2-NM	84	168	168	252	421	631	631	1262	1683	2104	3366	4207	
SF	1.50	1.50	2.00	2.00	1.50	1.33	1.67	1.67	1.50	1.60	1.50	1.50		

All dimensions are in mm unless otherwise specified, In view of our constant endeavor to improve the quality of our products, we reserve the right to alter or change specifications without prior notice.

2G... Co Axial Helical Gear Reducer

15	MODEL	H-50	H-60	H-70	H-80	H-90	H-100	H-112	H-125	H-140	H-160	H-180	H-200	
	RATIO	20	20	20	20	20	20	20	20	20	20	20	20	20
	N2(O/P RPM)	75	75	75	75	75	75	75	75	75	75	75	75	75
	HP1	1.5	2.5	4	5	7.5	10	12.5	25	30	40	60	75	
	KW1	1.125	1.875	3	3.75	5.625	7.5	9.375	18.75	22.5	30	45	56.25	
	T2-NM	140	234	374	467	701	935	1169	2337	2805	3740	5610	7012	
	DE	98	98	98	98	98	98	98	98	98	98	98	98	98
	M-HP1	1	1.5	2	3	5	7.5	7.5	15	20	25	40	50	
	M-KW1	0.75	1.125	1.5	2.25	3.75	5.625	5.625	11.25	15	18.75	30	37.5	
	M-T2-NM	93	140	187	280	467	701	701	1402	1870	2337	3740	4675	
SF	1.50	1.67	2.00	1.67	1.50	1.33	1.67	1.67	1.67	1.50	1.60	1.50	1.50	

16	MODEL	H-50	H-60	H-70	H-80	H-90	H-100	H-112	H-125	H-140	H-160	H-180	H-200	
	RATIO	22.5	22.5	22.5	22.5	22.5	22.5	22.5	22.5	22.5	22.5	22.5	22.5	22.5
	N2(O/P RPM)	66.6667	66.667	66.667	66.667	66.667	66.667	66.667	66.667	66.667	66.667	66.667	66.667	66.667
	HP1	1.5	2.5	4	5	6.5	7.5	10	20	25	30	45	60	
	KW1	1.125	1.875	3	3.75	4.875	5.625	7.5	15	18.75	22.5	33.75	45	
	T2-NM	158	263	421	526	684	789	1052	2104	2629	3155	4733	6311	
	DE	98	98	98	98	98	98	98	98	98	98	98	98	98
	M-HP1	1	1.5	2	3	5	5	7.5	12.5	15	20	30	40	
	M-KW1	0.75	1.125	1.5	2.25	3.75	3.75	5.625	9.375	11.25	15	22.5	30	
	M-T2-NM	105	158	210	316	526	526	789	1315	1578	2104	3155	4207	
SF	1.50	1.67	2.00	1.67	1.30	1.50	1.33	1.60	1.67	1.50	1.50	1.50		

17	MODEL	H-50	H-60	H-70	H-80	H-90	H-100	H-112	H-125	H-140	H-160	H-180	H-200	
	RATIO	25	25	25	25	25	25	25	25	25	25	25	25	
	N2(O/P RPM)	60	60	60	60	60	60	60	60	60	60	60	60	
	HP1	1	2	4	5	6.5	7.5	10	20	25	30	45	60	
	KW1	0.75	1.5	3	3.75	4.875	5.625	7.5	15	18.75	22.5	33.75	45	
	T2-NM	117	234	467	584	760	876	1169	2337	2922	3506	5259	7012	
	DE	98	98	98	98	98	98	98	98	98	98	98	98	98
	M-HP1	0.75	1	2	3	5	5	7.5	12.5	15	20	30	40	
	M-KW1	0.5625	0.75	1.5	2.25	3.75	3.75	5.625	9.375	11.25	15	22.5	30	
	M-T2-NM	88	117	234	351	584	584	876	1461	1753	2337	3506	4675	
SF	1.33	2.00	2.00	1.67	1.30	1.50	1.33	1.60	1.67	1.50	1.50	1.50		

18	MODEL	H-50	H-60	H-70	H-80	H-90	H-100	H-112	H-125	H-140	H-160	H-180	H-200	
	RATIO	28	28	28	28	28	28	28	28	28	28	28	28	
	N2(O/P RPM)	53.5714	53.571	53.571	53.571	53.571	53.571	53.571	53.571	53.571	53.571	53.571	53.571	
	HP1	1	2	3	4	6	7.5	10	15	20	25	35	45	
	KW1	0.75	1.5	2.25	3	4.5	5.625	7.5	11.25	15	18.75	26.25	33.75	
	T2-NM	131	262	393	524	785	982	1309	1963	2618	3272	4581	5890	
	DE	98	98	98	98	98	98	98	98	98	98	98	98	98
	M-HP1	0.75	1.5	2	2	3	5	7.5	10	12.5	15	20	30	
	M-KW1	0.5625	1.125	1.5	1.5	2.25	3.75	5.625	7.5	9.375	11.25	15	22.5	
	M-T2-NM	98	196	262	262	393	654	982	1309	1636	1963	2618	3927	
SF	1.33	1.33	1.50	2.00	2.00	1.50	1.33	1.50	1.60	1.67	1.75	1.50		

19	MODEL	H-50	H-60	H-70	H-80	H-90	H-100	H-112	H-125	H-140	H-160	H-180	H-200	
	RATIO	31.5	31.5	31.5	31.5	31.5	31.5	31.5	31.5	31.5	31.5	31.5	31.5	
	N2(O/P RPM)	47.619	47.619	47.619	47.619	47.619	47.619	47.619	47.619	47.619	47.619	47.619	47.619	
	HP1	1	2	3	4	5	6	7.5	15	20	25	35	45	
	KW1	0.75	1.5	2.25	3	3.75	4.5	5.625	11.25	15	18.75	26.25	33.75	
	T2-NM	147	294	442	589	736	883	1104	2209	2945	3681	5154	6626	
	DE	98	98	98	98	98	98	98	98	98	98	98	98	98
	M-HP1	0.75	1.5	2	3	3	3	5	10	12.5	15	20	30	
	M-KW1	0.5625	1.125	1.5	2.25	2.25	2.25	3.75	7.5	9.375	11.25	15	22.5	
	M-T2-NM	110	221	294	442	442	442	736	1472	1841	2209	2945	4417	
SF	1.33	1.33	1.50	1.33	1.67	2.00	1.50	1.50	1.60	1.67	1.75	1.50		

All dimensions are in mm unless otherwise specified. In view of our constant endeavor to improve the quality of our products, we reserve the right to alter or change specifications without prior notice.

2G... Co Axial Helical Gear Reducer

20	MODEL	H-50	H-60	H-70	H-80	H-90	H-100	H-112	H-125	H-140	H-160	H-180	H-200	
	RATIO	35.5	35.5	35.5	35.5	35.5	35.5	35.5	35.5	35.5	35.5	35.5	35.5	35.5
	N2(O/P RPM)	42.2535	42.254	42.254	42.254	42.254	42.254	42.254	42.254	42.254	42.254	42.254	42.254	42.254
	HP1	1	2	2.5	3	4	5	6	10	15	20	30	40	
	KW1	0.75	1.5	1.875	2.25	3	3.75	4.5	7.5	11.25	15	22.5	30	
	T2-NM	166	332	415	498	664	830	996	1659	2489	3319	4978	6638	
	DE	98	98	98	98	98	98	98	98	98	98	98	98	98
	M-HP1	0.75	1.5	1.5	2	3	3	3	7.5	10	12.5	20	25	
	M-KW1	0.5625	1.125	1.125	1.5	2.25	2.25	2.25	5.625	7.5	9.375	15	18.75	
	M-T2-NM	124	249	249	332	498	498	498	1245	1659	2074	3319	4149	
SF	1.33	1.33	1.67	1.50	1.33	1.67	2.00	1.33	1.50	1.60	1.50	1.60		

21	MODEL	H-50	H-60	H-70	H-80	H-90	H-100	H-112	H-125	H-140	H-160	H-180	H-200	
	RATIO	40	40	40	40	40	40	40	40	40	40	40	40	
	N2(O/P RPM)	37.5	37.5	37.5	37.5	37.5	37.5	37.5	37.5	37.5	37.5	37.5	37.5	
	HP1	1	1.5	2	3	4	5	6	7.5	12.5	20	30	40	
	KW1	0.75	1.125	1.5	2.25	3	3.75	4.5	5.625	9.375	15	22.5	30	
	T2-NM	187	280	374	561	748	935	1122	1402	2337	3740	5610	7479	
	DE	98	98	98	98	98	98	98	98	98	98	98	98	98
	M-HP1	0.75	1	1.5	2	3	3	3	5	7.5	12.5	20	25	
	M-KW1	0.5625	0.75	1.125	1.5	2.25	2.25	2.25	3.75	5.625	9.375	15	18.75	
	M-T2-NM	140	187	280	374	561	561	561	935	1402	2337	3740	4675	
SF	1.33	1.50	1.33	1.50	1.33	1.67	2.00	1.50	1.67	1.60	1.50	1.60		

2G... Co Axial Helical Gear Reducer

Input 1500rpm (Three Stage)

Sr. No.	MODEL	H-50/3	H-60/3	H-70/3	H-80/3	H-90/3	H-100/3	H-112/3	H-125/3	H-140/3	H-160/3	H-180/3	H-200/3
1	RATIO	14.4	14.4	14.4	14.4	14.4	14.4	14.4	14.4	14.4	14.4	14.4	14.4
	N2(O/P RPM)	104.17	104.17	104.17	104.17	104.17	104.17	104.17	104.17	104.17	104.17	104.17	104.17
	HP1	2.5	5	6	8	12	18	23	25	30	35	52	60
	KW1	1.88	3.75	4.5	6	9	13.5	17.25	18.75	22.5	26.25	39	45
	T2-NM	168	337	404	539	808	1212	1548	1683	2019	2356	3500	4039
	DE	98	98	98	98	98	98	98	98	98	98	98	98
	M-HP1	2	3	3	5	7.5	10	15	20	20	25	30	40
	M-KW1	1.5	2.25	2.25	3.75	5.63	7.5	11.25	15	15	18.75	22.5	30
	M-T2-NM	135	202	202	337	505	673	1010	1346	1346	1683	2019	2693
	SF	1.25	1.67	2.00	1.60	1.60	1.80	1.53	1.25	1.50	1.40	1.73	1.50

	MODEL	H-50/3	H-60/3	H-70/3	H-80/3	H-90/3	H-100/3	H-112/3	H-125/3	H-140/3	H-160/3	H-180/3	H-200/3
2	RATIO	16.8	16.8	16.8	16.8	16.8	16.8	16.8	16.8	16.8	16.8	16.8	16.8
	N2(O/P RPM)	89.29	89.29	89.29	89.29	89.29	89.29	89.29	89.29	89.29	89.29	89.29	89.29
	HP1	2.5	5	6	8	12	18	23	25	30	35	52	60
	KW1	1.88	3.75	4.5	6	9	13.5	17.25	18.75	22.5	26.25	39	45
	T2-NM	196	393	471	628	942	1414	1806	1963	2356	2749	4084	4712
	DE	98	98	98	98	98	98	98	98	98	98	98	98
	M-HP1	2	3	3	5	7.5	10	15	20	20	25	30	40
	M-KW1	1.5	2.25	2.25	3.75	5.63	7.5	11.25	15	15	18.75	22.5	30
	M-T2-NM	33	49	49	82	123	164	245	327	327	409	491	654
	SF	1.25	1.67	2.00	1.60	1.60	1.80	1.53	1.25	1.50	1.40	1.73	1.50

	MODEL	H-50/3	H-60/3	H-70/3	H-80/3	H-90/3	H-100/3	H-112/3	H-125/3	H-140/3	H-160/3	H-180/3	H-200/3
3	RATIO	20.4	20.4	20.4	20.4	20.4	20.4	20.4	20.4	20.4	20.4	20.4	20.4
	N2(O/P RPM)	73.53	73.53	73.53	73.53	73.53	73.53	73.53	73.53	73.53	73.53	73.53	73.53
	HP1	2.5	5	6	8	12	18	23	25	30	35	52	60
	KW1	1.88	3.75	4.5	6	9	13.5	17.25	18.75	22.5	26.25	39	45
	T2-NM	238	477	572	763	1144	1717	2193	2384	2861	3338	4959	5722
	DE	98	98	98	98	98	98	98	98	98	98	98	98
	M-HP1	2	3	3	5	7.5	10	15	20	20	25	30	40
	M-KW1	1.5	2.25	2.25	3.75	5.63	7.5	11.25	15	15	18.75	22.5	30
	M-T2-NM	40	60	60	99	149	199	298	397	397	497	596	795
	SF	1.25	1.67	2.00	1.60	1.60	1.80	1.53	1.25	1.50	1.40	1.73	1.50

	MODEL	H-50/3	H-60/3	H-70/3	H-80/3	H-90/3	H-100/3	H-112/3	H-125/3	H-140/3	H-160/3	H-180/3	H-200/3
4	RATIO	23.04	23.04	23.04	23.04	23.04	23.04	23.04	23.04	23.04	23.04	23.04	23.04
	N2(O/P RPM)	65.10	65.10	65.10	65.10	65.10	65.10	65.10	65.10	65.10	65.10	65.10	65.10
	HP1	2.5	5	6	8	12	18	23	25	30	35	52	60
	KW1	1.88	3.75	4.5	6	9	13.5	17.25	18.75	22.5	26.25	39	45
	T2-NM	269	539	646	862	1292	1939	2477	2693	3231	3770	5601	6462
	DE	98	98	98	98	98	98	98	98	98	98	98	98
	M-HP1	2	3	3	5	7.5	10	15	20	20	25	30	40
	M-KW1	1.5	2.25	2.25	3.75	5.63	7.5	11.25	15	15	18.75	22.5	30
	M-T2-NM	45	67	67	112	168	224	337	449	449	561	673	898
	SF	1.25	1.67	2.00	1.60	1.60	1.80	1.53	1.25	1.50	1.40	1.73	1.50

2G... Co Axial Helical Gear Reducer

5	MODEL	H-50/3	H-60/3	H-70/3	H-80/3	H-90/3	H-100/3	H-112/3	H-125/3	H-140/3	H-160/3	H-180/3	H-200/3
	RATIO	28.8	28.8	28.8	28.8	28.8	28.8	28.8	28.8	28.8	28.8	28.8	28.8
	N2(0/P RPM)	52.08	52.08	52.08	52.08	52.08	52.08	52.08	52.08	52.08	52.08	52.08	52.08
	HP1	2.5	5	6	8	12	18	23	25	30	35	52	60
	KW1	1.88	3.75	4.5	6	9	13.5	17.25	18.75	22.5	26.25	39	45
	T2-NM	337	673	808	1077	1616	2423	3096	3366	4039	4712	7001	8078
	DE	98	98	98	98	98	98	98	98	98	98	98	98
	M-HP1	2	3	3	5	7.5	10	15	20	20	25	30	40
	M-KW1	1.5	2.25	2.25	3.75	5.63	7.5	11.25	15	15	18.75	22.5	30
	M-T2-NM	56	84	84	140	210	280	421	561	561	701	841	1122
SF	1.25	1.67	2.00	1.60	1.60	1.80	1.53	1.25	1.50	1.40	1.73	1.50	

6	MODEL	H-50/3	H-60/3	H-70/3	H-80/3	H-90/3	H-100/3	H-112/3	H-125/3	H-140/3	H-160/3	H-180/3	H-200/3
	RATIO	33.6	33.6	33.6	33.6	33.6	33.6	33.6	33.6	33.6	33.6	33.6	33.6
	N2(0/P RPM)	44.64	44.64	44.64	44.64	44.64	44.64	44.64	44.64	44.64	44.64	44.64	44.64
	HP1	2.5	5	6	8	12	18	23	25	30	35	52	60
	KW1	1.88	3.75	4.5	6	9	13.5	17.25	18.75	22.5	26.25	39	45
	T2-NM	393	785	942	1257	1885	2827	3613	3927	4712	5497	8167	9424
	DE	98	98	98	98	98	98	98	98	98	98	98	98
	M-HP1	2	3	3	5	7.5	10	15	20	20	25	30	40
	M-KW1	1.5	2.25	2.25	3.75	5.63	7.5	11.25	15	15	18.75	22.5	30
	M-T2-NM	65	98	98	164	245	327	491	654	654	818	982	1309
SF	1.25	1.67	2.00	1.60	1.60	1.80	1.53	1.25	1.50	1.40	1.73	1.50	

7	MODEL	H-50/3	H-60/3	H-70/3	H-80/3	H-90/3	H-100/3	H-112/3	H-125/3	H-140/3	H-160/3	H-180/3	H-200/3
	RATIO	38.4	38.4	38.4	38.4	38.4	38.4	38.4	38.4	38.4	38.4	38.4	38.4
	N2(0/P RPM)	39.06	39.06	39.06	39.06	39.06	39.06	39.06	39.06	39.06	39.06	39.06	39.06
	HP1	2.5	5	6	8	12	18	23	25	30	35	52	60
	KW1	1.88	3.75	4.5	6	9	13.5	17.25	18.75	22.5	26.25	39	45
	T2-NM	449	898	1077	1436	2154	3231	4129	4488	5385	6283	9334	10770
	DE	98	98	98	98	98	98	98	98	98	98	98	98
	M-HP1	2	3	3	5	7.5	10	15	20	20	25	30	40
	M-KW1	1.5	2.25	2.25	3.75	5.63	7.5	11.25	15	15	18.75	22.5	30
	M-T2-NM	75	112	112	187	280	374	561	748	748	935	1122	1496
SF	1.25	1.67	2.00	1.60	1.60	1.80	1.53	1.25	1.50	1.40	1.73	1.50	

8	MODEL	H-50/3	H-60/3	H-70/3	H-80/3	H-90/3	H-100/3	H-112/3	H-125/3	H-140/3	H-160/3	H-180/3	H-200/3
	RATIO	43.2	43.2	43.2	43.2	43.2	43.2	43.2	43.2	43.2	43.2	43.2	43.2
	N2(0/P RPM)	34.72	34.72	34.72	34.72	34.72	34.72	34.72	34.72	34.72	34.72	34.72	34.72
	HP1	2.5	5	6	8	12	18	23	25	30	35	52	60
	KW1	1.88	3.75	4.5	6	9	13.5	17.25	18.75	22.5	26.25	39	45
	T2-NM	505	1010	1212	1616	2423	3635	4645	5049	6058	7068	10501	12117
	DE	98	98	98	98	98	98	98	98	98	98	98	98
	M-HP1	2	3	3	5	7.5	10	15	20	20	25	30	40
	M-KW1	1.5	2.25	2.25	3.75	5.63	7.5	11.25	15	15	18.75	22.5	30
	M-T2-NM	84	126	126	210	316	421	631	841	841	1052	1262	1683
SF	1.25	1.67	2.00	1.60	1.60	1.80	1.53	1.25	1.50	1.40	1.73	1.50	

2G... Co Axial Helical Gear Reducer

9	MODEL	H-50/3	H-60/3	H-70/3	H-80/3	H-90/3	H-100/3	H-112/3	H-125/3	H-140/3	H-160/3	H-180/3	H-200/3	
	RATIO	48	48	48	48	48	48	48	48	48	48	48	48	48
	N2(0/P RPM)	31.25	31.25	31.25	31.25	31.25	31.25	31.25	31.25	31.25	31.25	31.25	31.25	31.25
	HP1	0.63	1.31	1.51	2.33	3.21	4.02	4.90	7.34	8.78	9.79	14.32	18.82	
	KW1	0.47	0.99	1.13	1.75	2.41	3.01	3.67	5.51	6.59	7.34	10.74	14.11	
	T2-NM	144	301	347	534	737	920	1122	1682	2012	2244	3282	4313	
	DE	98	98	98	98	98	98	98	98	98	98	98	98	98
	M-HP1	0.5	1	1	1.5	2	2	3	5	5	7.5	10	12.5	
	M-KW1	0.375	0.75	0.75	1.125	1.5	1.5	2.25	3.75	3.75	5.625	7.5	9.375	
	M-T2-NM	112	224	224	337	449	449	673	1122	1122	1683	2244	2805	
SF	1.26	1.31	1.51	1.55	1.61	2.01	1.63	1.47	1.76	1.31	1.43	1.51		

10	MODEL	H-50/3	H-60/3	H-70/3	H-80/3	H-90/3	H-100/3	H-112/3	H-125/3	H-140/3	H-160/3	H-180/3	H-200/3
	RATIO	53.76	53.76	53.76	53.76	53.76	53.76	53.76	53.76	53.76	53.76	53.76	53.76
	N2(0/P RPM)	27.90	27.90	27.90	27.90	27.90	27.90	27.90	27.90	27.90	27.90	27.90	27.90
	HP1	0.65	0.98	1.29	1.92	2.65	3.23	3.78	6.38	7.76	10.09	14.38	18.90
	KW1	0.48	0.74	0.96	1.44	1.99	2.42	2.84	4.78	5.82	7.57	10.79	14.17
	T2-NM	166	252	330	492	680	829	971	1637	1991	2590	3692	4850
	DE	98	98	98	98	98	98	98	98	98	98	98	98
	M-HP1	0.5	0.5	0.75	1	1.5	2	2	3	5	5	7.5	10
	M-KW1	0.375	0.375	0.5625	0.75	1.13	1.5	1.5	2.25	3.75	3.75	5.625	7.5
	M-T2-NM	126	126	188	251	377	503	503	754	1257	1257	1885	2513
SF	1.29	1.96	1.71	1.92	1.77	1.62	1.89	2.13	1.55	2.02	1.92	1.89	

11	MODEL	H-50/3	H-60/3	H-70/3	H-80/3	H-90/3	H-100/3	H-112/3	H-125/3	H-140/3	H-160/3	H-180/3	H-200/3
	RATIO	60	60	60	60	60	60	60	60	60	60	60	60
	N2(0/P RPM)	25	25	25	25	25	25	25	25	25	25	25	25
	HP1	0.50	1.00	1.21	2.04	2.70	3.14	3.49	6.27	7.15	9.79	14.31	18.81
	KW1	0.38	0.75	0.91	1.53	2.02	2.35	2.62	4.70	5.36	7.34	10.73	14.11
	T2-NM	144	287	348	584	773	899	1000	1796	2048	2804	4099	5389
	DE	98	98	98	98	98	98	98	98	98	98	98	98
	M-HP1	0.25	0.5	1	1.5	1.5	2	2	3	5	5	7.5	10
	M-KW1	0.1875	0.375	0.75	1.125	1.13	1.5	1.5	2.25	3.75	3.75	5.625	7.5
	M-T2-NM	70	140	280	421	421	561	561	841	1402	1402	2104	2805
SF	2.01	2.00	1.21	1.36	1.80	1.57	1.74	2.09	1.43	1.96	1.91	1.88	

12	MODEL	H-50/3	H-60/3	H-70/3	H-80/3	H-90/3	H-100/3	H-112/3	H-125/3	H-140/3	H-160/3	H-180/3	H-200/3
	RATIO	67.2	67.2	67.2	67.2	67.2	67.2	67.2	67.2	67.2	67.2	67.2	67.2
	N2(0/P RPM)	22.32	22.32	22.32	22.32	22.32	22.32	22.32	22.32	22.32	22.32	22.32	22.32
	HP1	0.48	0.79	1.26	1.59	2.06	3.08	3.77	6.01	7.39	10.06	14.71	18.48
	KW1	0.36	0.59	0.94	1.19	1.55	2.31	2.83	4.51	5.54	7.54	11.03	13.86
	T2-NM	154	252	403	511	662	988	1210	1928	2371	3227	4718	5928
	DE	98	98	98	98	98	98	98	98	98	98	98	98
	M-HP1	0.33	0.5	0.75	1	1	2	2	3	5	7.5	10	12.5
	M-KW1	0.2475	0.375	0.5625	0.75	0.75	1.5	1.5	2.25	3.75	5.625	7.5	9.375
	M-T2-NM	104	157	236	314	314	628	628	942	1571	2356	3141	3927
SF	1.45	1.57	1.68	1.59	2.06	1.54	1.88	2.00	1.48	1.34	1.47	1.48	

2G... Co Axial Helical Gear Reducer

13	MODEL	H-50/3	H-60/3	H-70/3	H-80/3	H-90/3	H-100/3	H-112/3	H-125/3	H-140/3	H-160/3	H-180/3	H-200/3
	RATIO	76.8	76.8	76.8	76.8	76.8	76.8	76.8	76.8	76.8	76.8	76.8	76.8
N2(0/P RPM)	19.53	19.53	19.53	19.53	19.53	19.53	19.53	19.53	19.53	19.53	19.53	19.53	19.53
HP1	0.49	0.70	1.26	1.64	1.91	3.06	3.73	5.74	7.64	9.57	13.98	18.38	
KW1	0.37	0.53	0.94	1.23	1.43	2.30	2.80	4.30	5.73	7.17	10.48	13.79	
T2-NM	180	257	462	600	700	1123	1367	2104	2803	3508	5126	6740	
DE	98	98	98	98	98	98	98	98	98	98	98	98	
M-HP1	0.33	0.5	3	3	5	7.5	10	15	20	25	40	50	
M-KW1	0.2475	0.375	2.25	2.25	3.75	5.63	7.5	11.25	15	18.75	30	37.5	
M-T2-NM	118	180	1077	1077	1795	2693	3590	5385	7180	8975	14360	17950	
SF	1.49	1.40	0.42	0.55	0.38	0.41	0.37	0.38	0.38	0.38	0.38	0.35	0.37

14	MODEL	H-50/3	H-60/3	H-70/3	H-80/3	H-90/3	H-100/3	H-112/3	H-125/3	H-140/3	H-160/3	H-180/3	H-200/3
	RATIO	86.4	86.4	86.4	86.4	86.4	86.4	86.4	86.4	86.4	86.4	86.4	86.4
N2(0/P RPM)	17.36	17.36	17.36	17.36	17.36	17.36	17.36	17.36	17.36	17.36	17.36	17.36	17.36
HP1	0.38	0.69	0.90	1.58	1.90	2.50	2.98	5.74	7.32	9.52	13.42	17.64	
KW1	0.28	0.52	0.68	1.19	1.42	1.87	2.23	4.30	5.49	7.14	10.07	13.23	
T2-NM	155	284	373	653	782	1030	1228	2368	3019	3926	5537	7278	
DE	98	98	98	98	98	98	98	98	98	98	98	98	
M-HP1	0.25	0.5	0.75	1	1	2	2	3	5	7.5	10	12.5	
M-KW1	0.19	0.38	0.56	0.75	0.75	1.5	1.5	2.25	3.75	5.63	7.5	9.38	
M-T2-NM	101	202	303	404	404	808	808	1212	2019	3029	4039	5049	
SF	1.50	1.38	1.21	1.58	1.90	1.25	1.49	1.91	1.46	1.27	1.34	1.41	

15	MODEL	H-50/3	H-60/3	H-70/3	H-80/3	H-90/3	H-100/3	H-112/3	H-125/3	H-140/3	H-160/3	H-180/3	H-200/3
	RATIO	96	96	96	96	96	96	96	96	96	96	96	96
N2(0/P RPM)	15.63	15.63	15.63	15.63	15.63	15.63	15.63	15.63	15.63	15.63	15.63	15.63	15.63
HP1	0.38	0.61	0.97	1.35	1.85	2.51	3.12	6.12	7.82	9.79	13.87	18.23	
KW1	0.28	0.46	0.72	1.01	1.39	1.88	2.34	4.59	5.86	7.34	10.40	13.67	
T2-NM	173	278	443	618	847	1150	1429	2804	3583	4488	6358	8356	
DE	98	98	98	98	98	98	98	98	98	98	98	98	
M-HP1	0.25	0.33	0.5	1	1	1.5	2	3	5	7.5	10	12.5	
M-KW1	0.19	0.25	0.38	0.75	0.75	1.125	1.5	2.25	3.75	5.63	7.5	9.38	
M-T2-NM	112	148	224	449	449	673	898	1346	2244	3366	4488	5610	
SF	1.51	1.84	1.93	1.35	1.85	1.67	1.56	2.04	1.56	1.31	1.39	1.46	

16	MODEL	H-50/3	H-60/3	H-70/3	H-80/3	H-90/3	H-100/3	H-112/3	H-125/3	H-140/3	H-160/3	H-180/3	H-200/3
	RATIO	108	108	108	108	108	108	108	108	108	108	108	108
N2(0/P RPM)	13.89	13.89	13.89	13.89	13.89	13.89	13.89	13.89	13.89	13.89	13.89	13.89	13.89
HP1	0.37	0.60	0.95	1.33	1.62	1.81	2.45	4.95	6.39	7.20	10.74	14.63	
KW1	0.28	0.45	0.71	1.00	1.21	1.36	1.84	3.72	4.79	5.40	8.05	10.97	
T2-NM	191	307	488	688	835	935	1262	2555	3294	3715	5538	7546	
DE	98	98	98	98	98	98	98	98	98	98	98	98	
M-HP1	0.25	0.33	0.5	0.75	1	1.5	2	3	5	5	7.5	10	
M-KW1	0.19	0.25	0.38	0.56	0.75	1.125	1.5	2.25	3.75	3.75	5.63	7.5	
M-T2-NM	126	167	252	379	505	757	1010	1515	2524	2524	3786	5049	
SF	1.48	1.81	1.89	1.78	1.62	1.21	1.22	1.65	1.28	1.44	1.43	1.46	

2G... Co Axial Helical Gear Reducer

17	MODEL	H-50/3	H-60/3	H-70/3	H-80/3	H-90/3	H-100/3	H-112/3	H-125/3	H-140/3	H-160/3	H-180/3	H-200/3
	RATIO	120	120	120	120	120	120	120	120	120	120	120	120
N2(0/P RPM)	12.50	12.50	12.50	12.50	12.50	12.50	12.50	12.50	12.50	12.50	12.50	12.50	12.50
HP1	0.25	0.48	0.95	1.35	1.64	1.85	2.45	4.89	6.39	7.21	10.47	15.43	
KW1	0.19	0.36	0.71	1.01	1.23	1.38	1.84	3.67	4.79	5.41	7.85	11.57	
T2-NM	142	274	542	772	938	1058	1403	2804	3659	4132	6000	8842	
DE	98	98	98	98	98	98	98	98	98	98	98	98	
M-HP1	0.25	0.33	0.5	1	1	1.5	2	3	3	5	7.5	10	
M-KW1	0.19	0.25	0.38	0.75	0.75	1.13	1.5	2.25	2.25	3.75	5.63	7.5	
M-T2-NM	140	185	280	561	561	841	1122	1683	1683	2805	4207	5610	
SF	0.99	1.45	1.89	1.35	1.64	1.23	1.22	1.63	2.13	1.44	1.40	1.54	

18	MODEL	H-50/3	H-60/3	H-70/3	H-80/3	H-90/3	H-100/3	H-112/3	H-125/3	H-140/3	H-160/3	H-180/3	H-200/3
	RATIO	134.4	134.4	134.4	134.4	134.4	134.4	134.4	134.4	134.4	134.4	134.4	134.4
N2(0/P RPM)	11.16	11.16	11.16	11.16	11.16	11.16	11.16	11.16	11.16	11.16	11.16	11.16	11.16
HP1	0.25	0.47	0.77	1.00	1.46	1.89	2.51	3.77	5.12	5.90	8.58	11.09	
KW1	0.19	0.36	0.58	0.75	1.09	1.42	1.88	2.83	3.84	4.42	6.43	8.32	
T2-NM	163	305	492	642	935	1213	1613	2419	3284	3786	5503	7116	
DE	98	98	98	98	98	98	98	98	98	98	98	98	
M-HP1	0.25	0.33	0.5	0.75	1	1.5	2	2	3	5	7.5	7.5	
M-KW1	0.19	0.25	0.38	0.56	0.75	1.125	1.5	1.5	2.25	3.75	5.63	5.63	
M-T2-NM	157	207	314	471	628	942	1257	1257	1885	3141	4712	4712	
SF	1.02	1.44	1.53	1.33	1.46	1.26	1.26	1.88	1.71	1.18	1.14	1.48	

19	MODEL	H-50/3	H-60/3	H-70/3	H-80/3	H-90/3	H-100/3	H-112/3	H-125/3	H-140/3	H-160/3	H-180/3	H-200/3
	RATIO	151.2	151.2	151.2	151.2	151.2	151.2	151.2	151.2	151.2	151.2	151.2	151.2
N2(0/P RPM)	9.92	9.92	9.92	9.92	9.92	9.92	9.92	9.92	9.92	9.92	9.92	9.92	9.92
HP1	0.25	0.49	0.74	1.11	1.19	1.37	1.97	3.79	5.14	5.72	8.29	11.20	
KW1	0.18	0.36	0.55	0.83	0.89	1.03	1.47	2.84	3.86	4.29	6.21	8.40	
T2-NM	178	350	532	802	859	991	1420	2735	3713	4130	5982	8086	
DE	98	98	98	98	98	98	98	98	98	98	98	98	
M-HP1	0.25	0.33	0.5	0.75	1	1	1.5	2	3	5	5	7.5	
M-KW1	0.19	0.25	0.38	0.56	0.75	0.75	1.125	1.5	2.25	3.75	3.75	5.63	
M-T2-NM	177	233	353	530	707	707	1060	1414	2120	3534	3534	5301	
SF	0.98	1.47	1.47	1.48	1.19	1.37	1.31	1.89	1.71	1.14	1.66	1.49	

20	MODEL	H-50/3	H-60/3	H-70/3	H-80/3	H-90/3	H-100/3	H-112/3	H-125/3	H-140/3	H-160/3	H-180/3	H-200/3
	RATIO	170.4	170.4	170.4	170.4	170.4	170.4	170.4	170.4	170.4	170.4	170.4	170.4
N2(0/P RPM)	8.80	8.80	8.80	8.80	8.80	8.80	8.80	8.80	8.80	8.80	8.80	8.80	8.80
HP1	0.24	0.50	0.59	0.77	0.97	1.21	1.49	2.41	3.69	4.57	6.93	10.07	
KW1	0.18	0.38	0.44	0.58	0.73	0.90	1.12	1.81	2.76	3.43	5.20	7.55	
T2-NM	197	409	479	630	788	982	1212	1963	2999	3718	5641	8195	
DE	98	98	98	98	98	98	98	98	98	98	98	98	
M-HP1	0.25	0.33	0.5	0.5	0.75	1	1	1.5	2	3	5	7.5	
M-KW1	0.19	0.25	0.38	0.38	0.56	0.75	0.75	1.125	1.5	2.25	3.75	5.63	
M-T2-NM	199	263	398	398	597	797	797	1195	1593	2390	3983	5974	
SF	0.97	1.52	1.18	1.55	1.29	1.21	1.49	1.61	1.84	1.52	1.39	1.34	

2G... Co Axial Helical Gear Reducer

	MODEL	H-50/3	H-60/3	H-70/3	H-80/3	H-90/3	H-100/3	H-112/3	H-125/3	H-140/3	H-160/3	H-180/3	H-200/3
21	RATIO	192	192	192	192	192	192	192	192	192	192	192	192
	N2(0/P RPM)	7.81	7.81	7.81	7.81	7.81	7.81	7.81	7.81	7.81	7.81	7.81	7.81
	HP1	0.23	0.40	0.47	0.84	0.93	1.30	1.47	1.75	2.92	5.18	6.93	9.72
	KW1	0.18	0.30	0.35	0.63	0.70	0.97	1.10	1.31	2.19	3.89	5.20	7.29
	T2-NM	215	362	428	766	852	1188	1346	1604	2677	4750	6358	8912
	DE	98	98	98	98	98	98	98	98	98	98	98	98
	M-HP1	0.25	0.33	0.5	0.5	0.75	1	1	1.5	2	3	5	7.5
	M-KW1	0.19	0.25	0.38	0.38	0.56	0.75	0.75	1.125	1.5	2.25	3.75	5.63
	M-T2-NM	224	296	449	449	673	898	898	1346	1795	2693	4488	6731
	SF	0.94	1.20	0.93	1.67	1.24	1.30	1.47	1.17	1.46	1.73	1.39	1.30