

# No Back Bearing

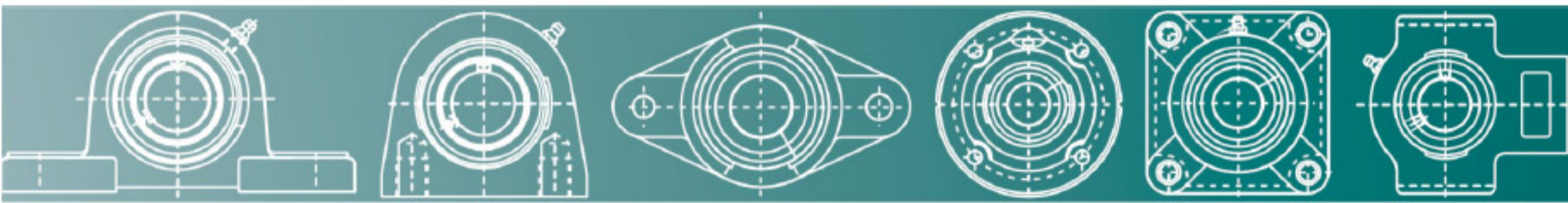

Race  
Inner & Outer



**Make** a triple sealed bearing unit  
**it a**  
**triple,**

Better seal protection provides longer life, resulting in **less down time & higher profits.**

Ideal for use in both industrial and agricultural applications.

**Product quality and reliability**  
**Superior Service**  
**Manufacturers price**  
**More than just your profit**

 **Yashimpex**

TECHNICAL SUPPORT : [sales@yash-impex.com](mailto:sales@yash-impex.com)

## No Back Bearing

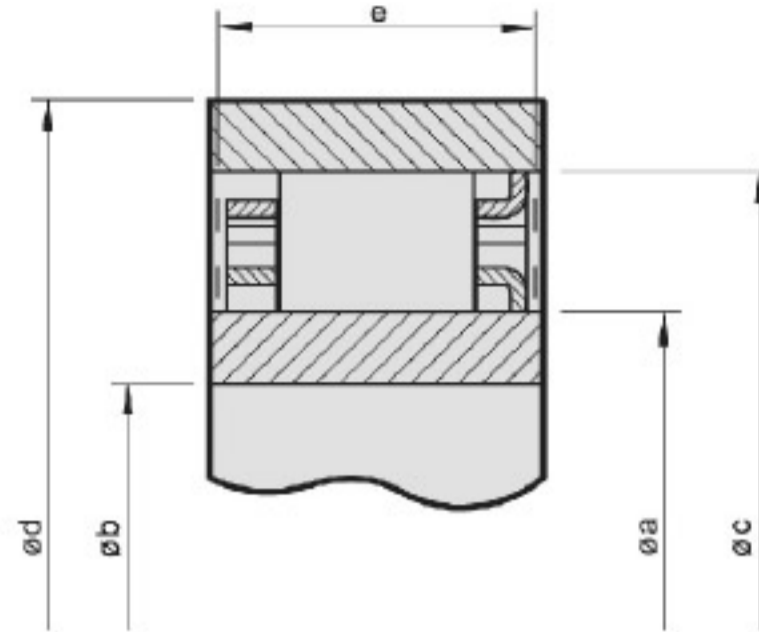
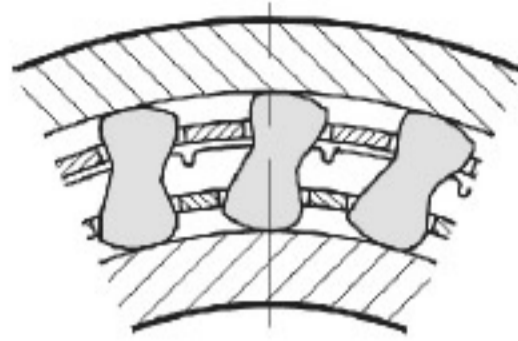

Model	$T_{KN}^{1)}$ (Nm)	Overrunning Speeds		$a^{+0.008}_{-0.005}$ (mm)	$c^{\pm 0.013}$ (mm)	Sprag space (mm)	$e_{min}$ (mm)	$d_{min}$ (mm)	$b_{max}$ (mm)	No of Dips	No of Sprags	Weight
		$n_{imax}^{2)}$ ( $min^{-1}$ )	$n_{amax}^{3)}$ ( $min^{-1}$ )									
DC2222G-N	63	8600	4300	22,225	38,885	8,33 ±0,075	10,0	50	15	–	12	0,030
DC2776-N	119	6900	3400	27,762	44,422	8,33 ±0,075	13,5	58	18	–	14	0,055
DC3034-N	124	6300	3100	30,340	47,000	8,33 ±0,075	13,5	62	20	–	14	0,060
DC3175(3C)-N	159	6000	3000	31,750	48,410	8,33 ±0,075	13,5	63	21	3	16	0,060
DC3809A-N	275	5000	2500	38,092	54,752	8,33 ±0,075	16,0	71	25	–	18	0,085
DC4127(3C)-N	224	4600	2300	41,275	57,935	8,33 ±0,075	13,5	75	27	3	18	0,090
DC4445A-N	363	4300	2100	44,450	61,110	8,33 ±0,1	16,0	79	29	–	20	0,095
DC4972(4C)-N	306	3800	1900	49,721	66,381	8,33 ±0,1	13,5	86	33	4	22	0,100
DC5476A-N	525	3500	1700	54,765	71,425	8,33 ±0,1	16,0	92	36	–	24	0,110
DC5476A(4C)-N	525	3500	1700	54,765	71,425	8,33 ±0,1	16,0	92	36	4	24	0,130
DC5476B(4C)-N	769	3500	1700	54,765	71,425	8,33 ±0,1	21,0	92	36	4	24	0,180
DC5476C(4C)-N	990	3500	1700	54,765	71,425	8,33 ±0,1	25,4	92	36	4	24	0,200
DC5776A-N	604	3300	1600	57,760	74,420	8,33 ±0,1	16,0	98	38	–	26	0,110
DC6334B-N	806	3000	1500	63,340	80,000	8,33 ±0,1	21,0	104	42	–	26	0,175
DC7221(5C)-N	675	2600	1300	72,217	88,877	8,33 ±0,1	13,5	115	48	5	30	0,140
DC7221B-N	1279	2600	1300	72,217	88,877	8,33 ±0,1	21,0	115	48	–	30	0,185
DC7221B(5C)-N	1279	2600	1300	72,217	88,877	8,33 ±0,1	21,0	115	48	5	30	0,210
DC7969C(5C)-N	2038	2400	1200	79,698	96,358	8,33 ±0,1	25,4	124	53	5	34	0,280
DC8334C-N	2055	2300	1100	83,340	1,00,000	8,33 ±0,1	25,4	132	55	–	34	0,270
DC8729A-N	1250	2200	1100	87,290	1,03,960	8,33 ±0,1	16,0	134	58	–	34	0,165
DC10323A(5C)*-N	1612	1800	900	103,231**	1,19,891	8,33 ±0,1	16,0	155	68	5	40	0,205
DC12334C*-N	4800	1500	750	123,340**	1,40,000	8,33 ±0,1	25,4	184	80	–	50	0,400
DC12388C(11C)	4875	1500	750	1,23,881	1,42,880	9,50 ±0,1	25,4	186	80	11	44	0,400

